

PART KIT INSTALL INSTRUCTIONS

Salford Aircarts

Part Kit #VARIES - Rev 2.0 - AIRGUARD - Blockage Prevention System

Release Date: 2024-04-11



| | | | |
|--------------|---|---------------------|------------|
| Title | Airguard Blockage Prevention System Upgrade Instructions | RELEASE DATE | 2024-04-11 |
| STEP | 1. Remove existing fan screen (Item 1) from the fan housing (Item 2). | REV # | 2.0 |
| | | PART KIT # | Varies |

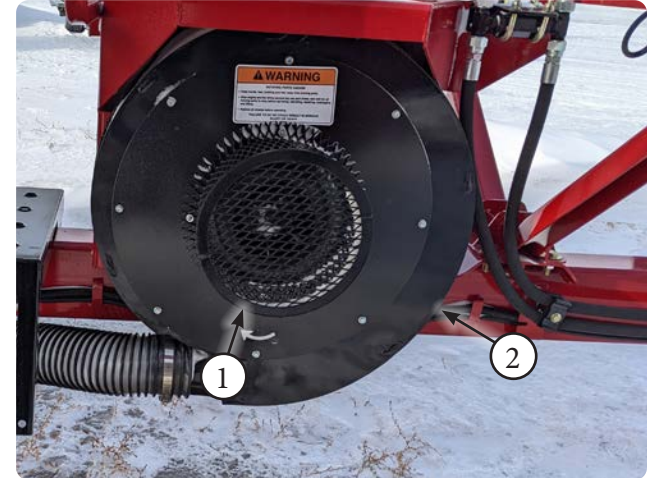
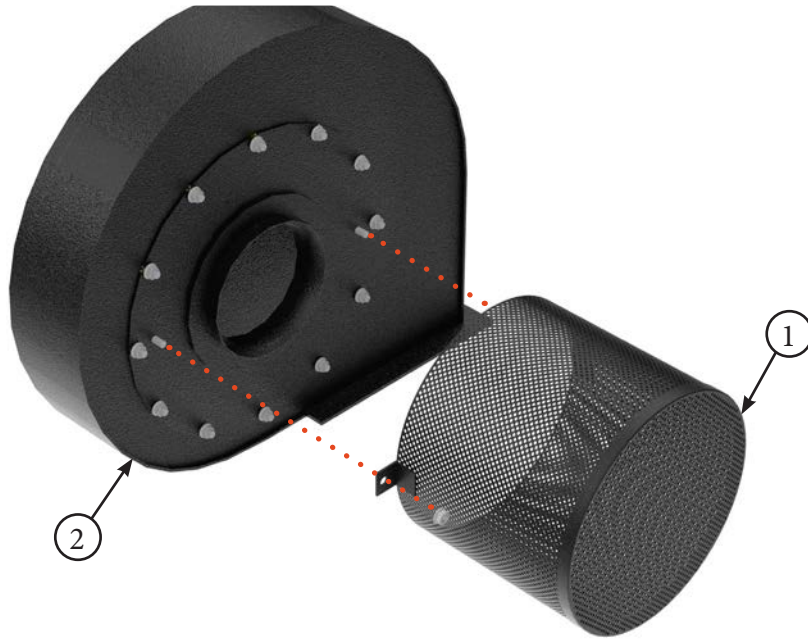

| PARTS LIST | | |
|------------|--------|-------------|
| Item | Part # | Description |
| 1 | -- | Fan Screen |

| PARTS LIST | | |
|------------|--------|-------------|
| Item | Part # | Description |
| 2 | -- | Fan Housing |

| | | | |
|--------------|--|---------------------|------------|
| Title | Airguard Blockage Prevention System Upgrade Instructions | RELEASE DATE | 2024-04-11 |
| STEP | 2. Install supplied mounting bracket (Item 1) to fan housing (Item 2) using existing bolts and nuts (Item 3). Angle mount bracket in a position that ensures the supplied hydraulic hoses reach the fan motor. Additional holes in bracket face (Item 4) are for easy access with an impact driver. Bracket may look different than shown below. | REV # | 2.0 |
| | | PART KIT # | Varies |

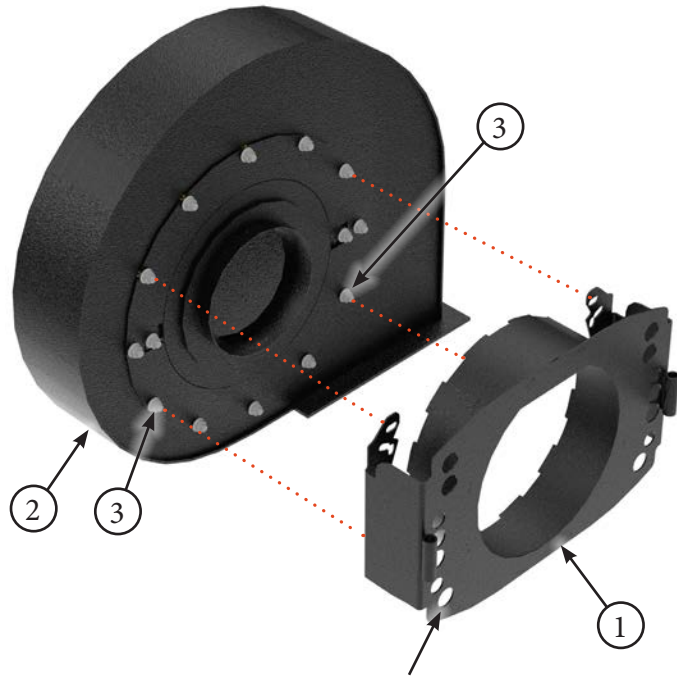

Additional holes in bracket face are for easy access with an impact driver.

Use Kit # 9520 for the following Models:

- AC1000
- AC2000
- 3605
- 8600/8700 Floater
- 9620 Floater



Use Kit # 9600 for the following Models:

- AC3000

Use Kit # 9030 for the following Models:

- 246
- 6056



| PARTS LIST | | |
|------------|----------------|--------------------------------|
| Item | Part # | Description |
| 1 | 7554 /or/ 9033 | 9520 Bracket /or/ 9030 Bracket |
| 2 | -- | Fan Housing |

| PARTS LIST | | |
|------------|--------|-------------------|
| Item | Part # | Description |
| 3 | -- | Existing Hardware |

| | | | |
|--------------|--|---------------------|------------|
| Title | Airguard Blockage Prevention System Upgrade Instructions | RELEASE DATE | 2024-04-11 |
| STEP | 3. Bolt Oil Cooler/Radiator Assembly (Item 1) to BP System Bracket (Item 2) using supplied 10mm x 25mm Bolts (Item 3) and 10mm lock nuts (Item 4). If only installing snorkel kit without Radiator, then install plastic plugs (Item 5) onto BP System Bracket (Item 2). This step of the installation may already be completed at the Airguard factory prior to shipping. | REV # | 2.0 |
| | | PART KIT # | Varies |

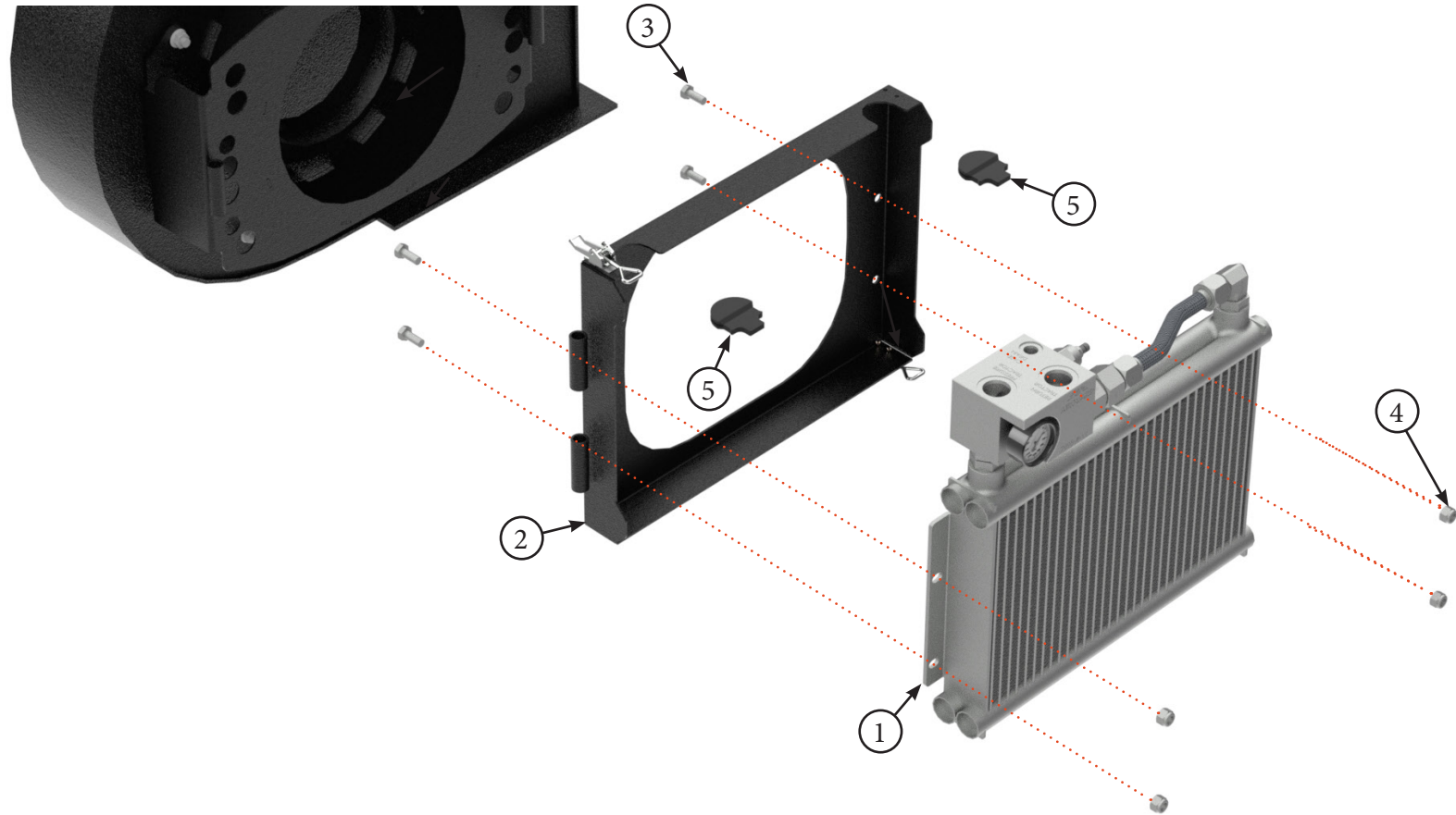

| PARTS LIST | | |
|------------|--------|----------------------------------|
| Item | Part # | Description |
| 1 | 7996 | Oil Cooler and Manifold Assembly |
| 2 | 7546 | Main BP System Bracket |
| 3 | 7515 | Hex Bolt, 10mm x 25mm Grade 8.8 |

| PARTS LIST | | |
|------------|--------|--------------------------|
| Item | Part # | Description |
| 4 | 7516 | Lock Nut, 10mm Grade 8.8 |
| 5 | 7683 | BP System Bracket Plug |

| | | | |
|--------------|---|---------------------|------------|
| Title | Airguard Blockage Prevention System Upgrade Instructions | RELEASE DATE | 2024-04-11 |
| STEP | 4. Remove the packaging materials prior to the assembly of these brackets. Mount BP System Main Bracket with Oil Cooler (Item 1) or Main Bracket with Plugs (Item 2) to Fan bracket (Item 3) using supplied pivot pins (Item 4). Secure in place with 3.5mm cotter pins (Item 5). | REV # | 2.0 |
| | | PART KIT # | Varies |

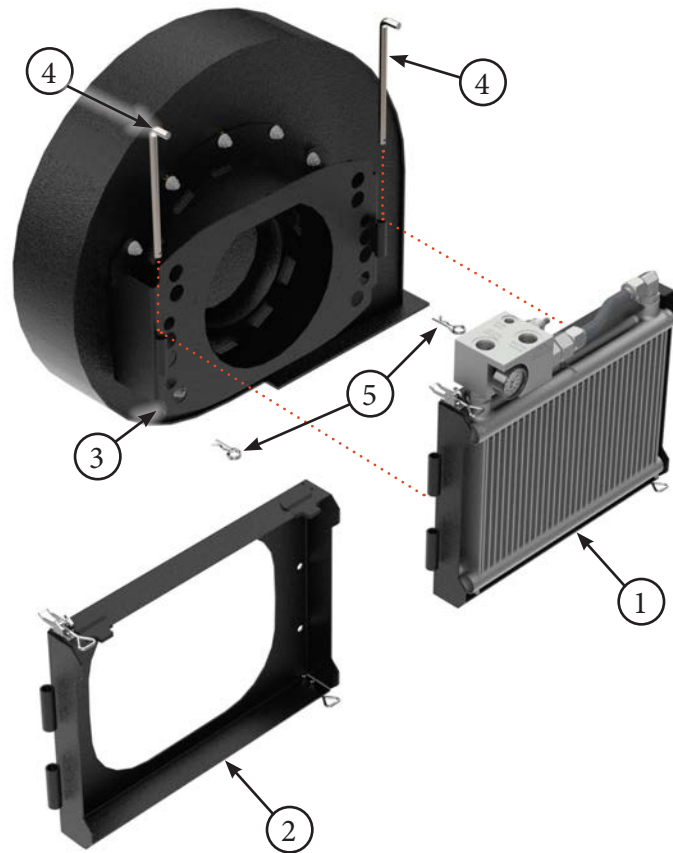

Remove Packaging material and discard, prior to install.



| PARTS LIST | | |
|------------|--------|--|
| Item | Part # | Description |
| 1 | -- | BP System Main Bracket with Oil Cooler |
| 2 | -- | BP System Main Bracket with Plugs for Snorkel Only Install |
| 3 | -- | Fan Bracket |

| PARTS LIST | | |
|------------|--------|--------------------------|
| Item | Part # | Description |
| 4 | 7502 | Pivot Pin For BP Systems |
| 5 | 7513 | 3.5mm Cotter Pin |

| | | | |
|--------------|--|---------------------|------------|
| Title | Airguard Blockage Prevention System Upgrade Instructions | RELEASE DATE | 2024-04-11 |
| STEP | 5. Attach Mesh Screen (Item 1) or Snorkel Housing (Item 2) to front of BPS using latches (Item 3). | REV # | 2.0 |
| | | PART KIT # | Varies |

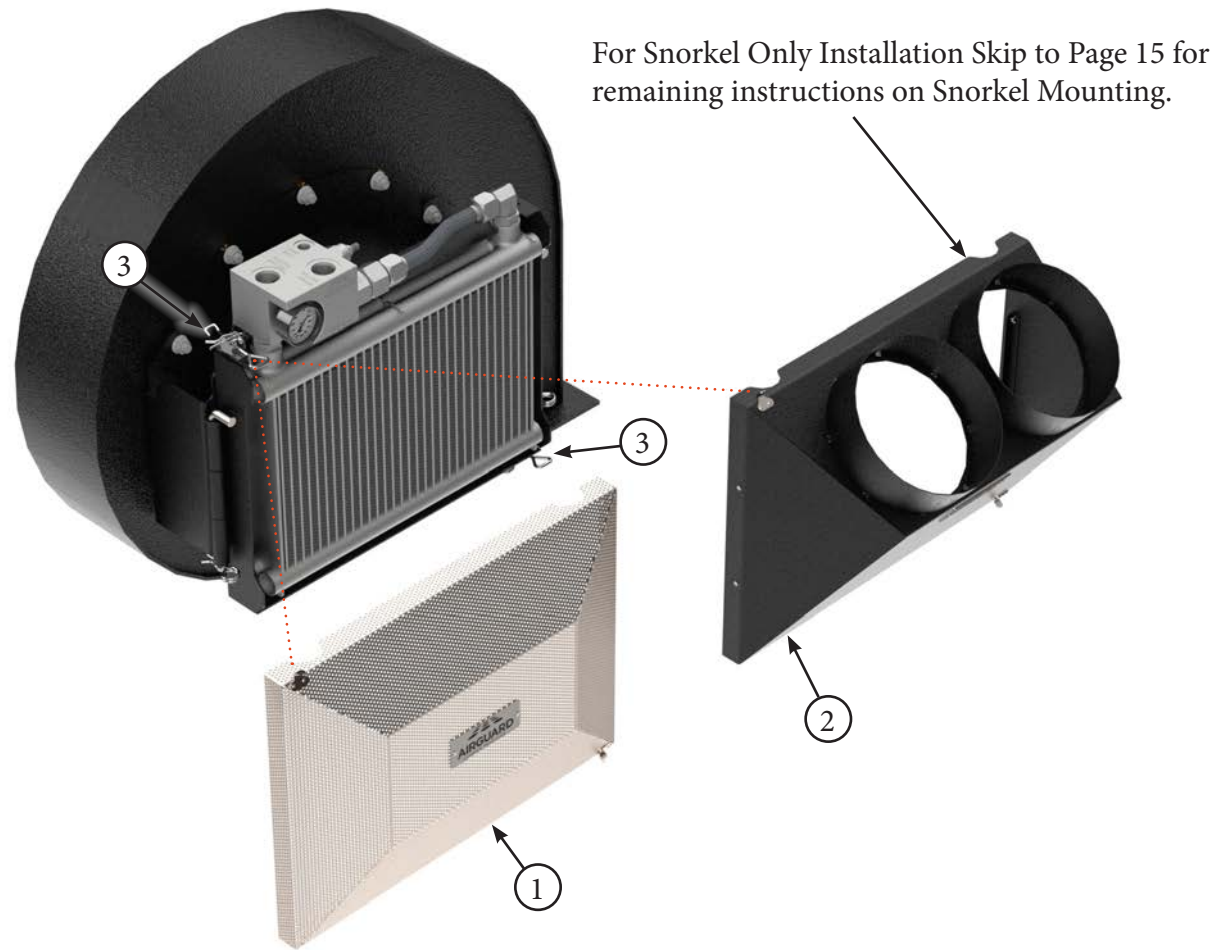

| PARTS LIST | | |
|------------|--------|-----------------|
| Item | Part # | Description |
| 1 | 7568 | Mesh Screen |
| 2 | 7977 | Snorkel Housing |

| PARTS LIST | | |
|------------|--------|------------------|
| Item | Part # | Description |
| 3 | -- | Overcenter Latch |

| | | | |
|-------|--|--------------|------------|
| Title | Airguard Blockage Prevention System Upgrade Instructions | RELEASE DATE | 2024-04-11 |
| STEP | 6. Identify the model of aircart that the Airguard Blockage Prevention System is being installed on. For models with external check valves, the connections must be made on the tractor side of the hydraulic circuit as shown below. | REV # | 2.0 |
| | | PART KIT # | Varies |

Installation with External Check Valve:

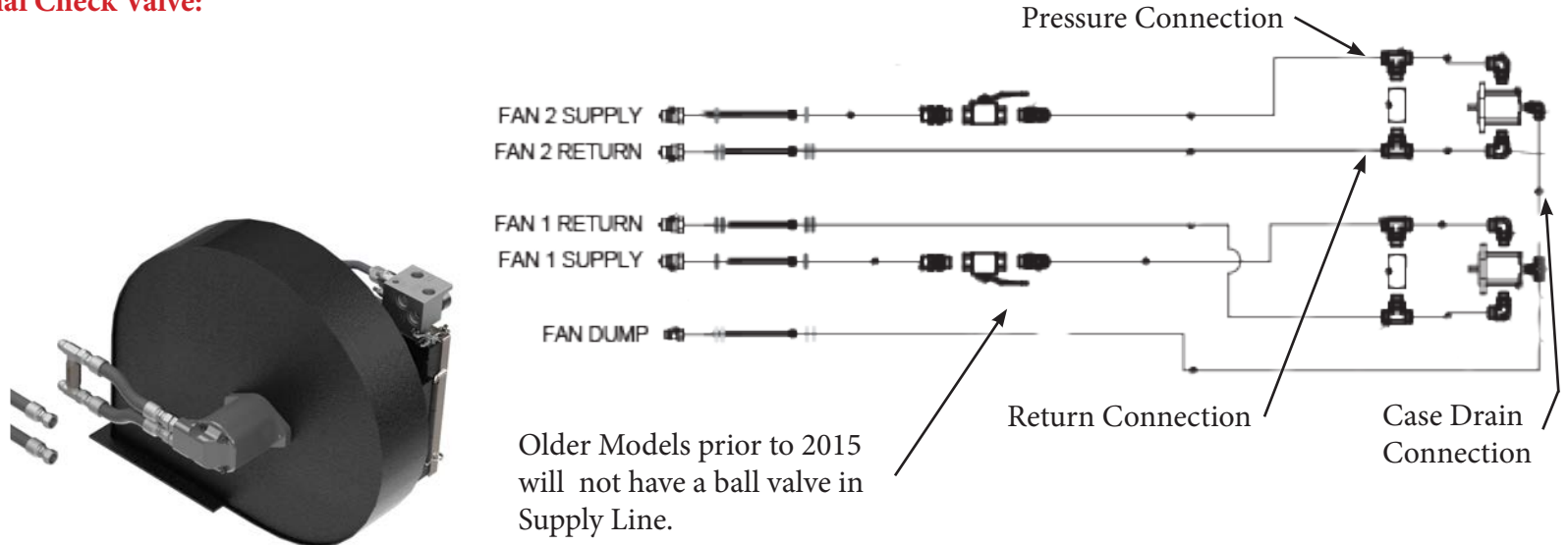

Installation with Internal Check Valve:

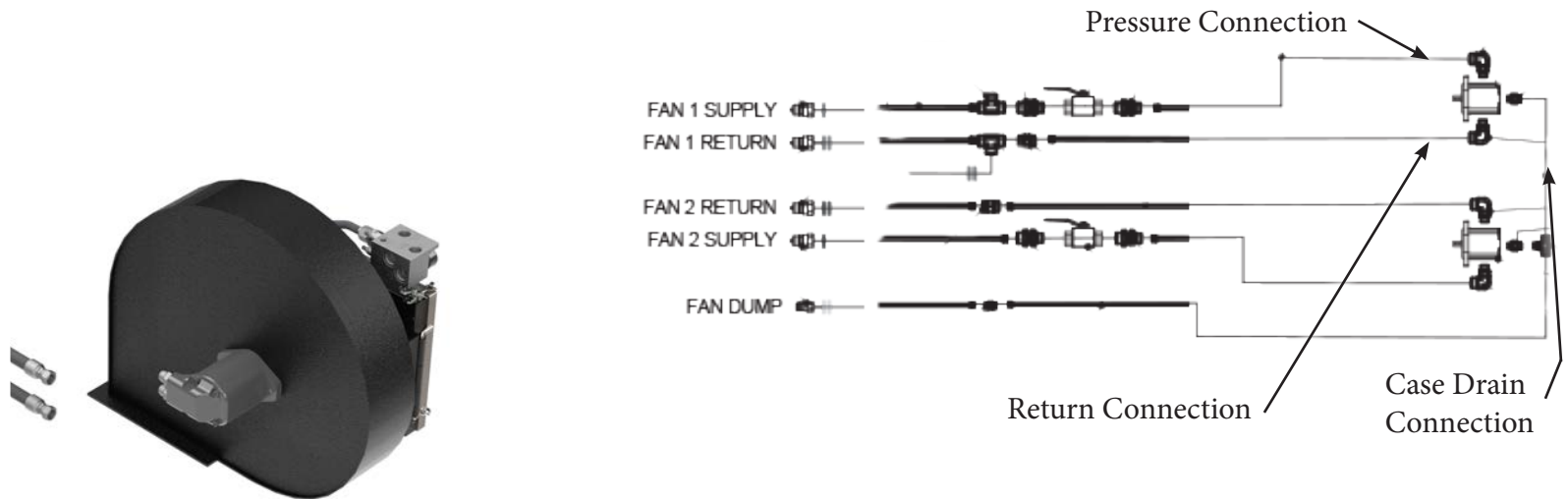

| | | | |
|--------------|---|---------------------|------------|
| Title | Airguard Blockage Prevention System Upgrade Instructions | RELEASE DATE | 2024-04-11 |
| STEP | 7. Remove factory hoses (Item 1) from side of fan motor (Item 2). Remove the hoses (Item 1) on the tractor side of the external check valve, as shown below. Identify which hose is the pressure side of the circuit. On newer models there is a shut off valve on the pressure side of the circuit. The external check valve will have a directional arrow that always points to the pressure side. If you do not have an external check valve you will attach directly to the fan motor. | REV # | 2.0 |
| | | PART KIT # | Varies |

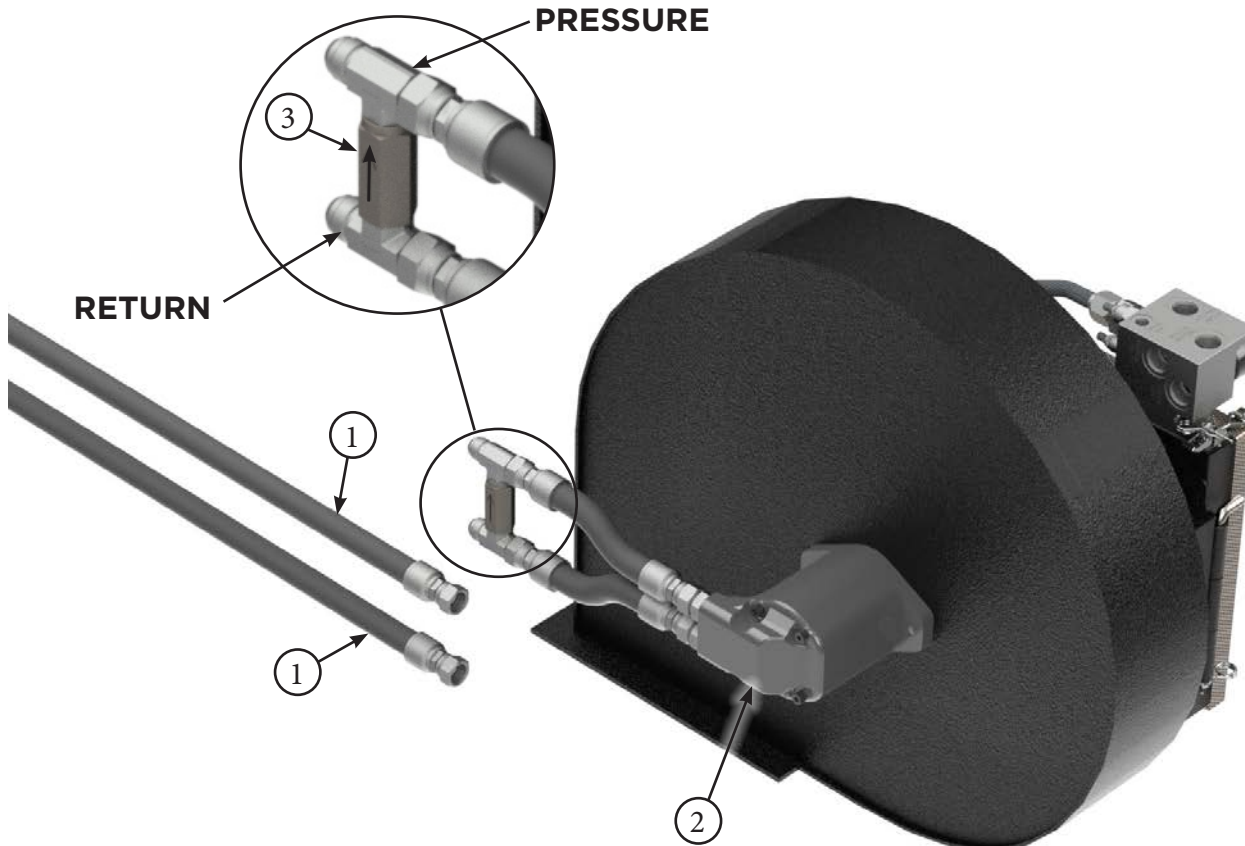

| PARTS LIST | | |
|------------|--------|---|
| Item | Part # | Description |
| 1 | -- | Existing Hose from Tractor to Fan Motor |
| 2 | -- | Hydraulic Motor |

| PARTS LIST | | |
|------------|--------|----------------------|
| Item | Part # | Description |
| 3 | -- | External Check Valve |

| | | | |
|--------------|---|---------------------|------------|
| Title | Airguard Bypass Kit Instructions | RELEASE DATE | 2024-04-11 |
| STEP | 8. Mount valve on bracket, using 6mm x 60mm bolts (Item 7) and 6mm lock nuts (Item 8) for top connection. Attach mount bracket (Item 1 & 2) to aircart HSS frame. Use 12mm x 110mm-160mm bolts (Item 3, 4 or 5) and 12mm lock nuts (Item 9) for bottom connection. Bracket is designed to fit HSS Beams 3”-5” x 3”-10” in vertical or horizontal mount positions. | REV # | 2.0 |
| | | PART KIT # | Varies |

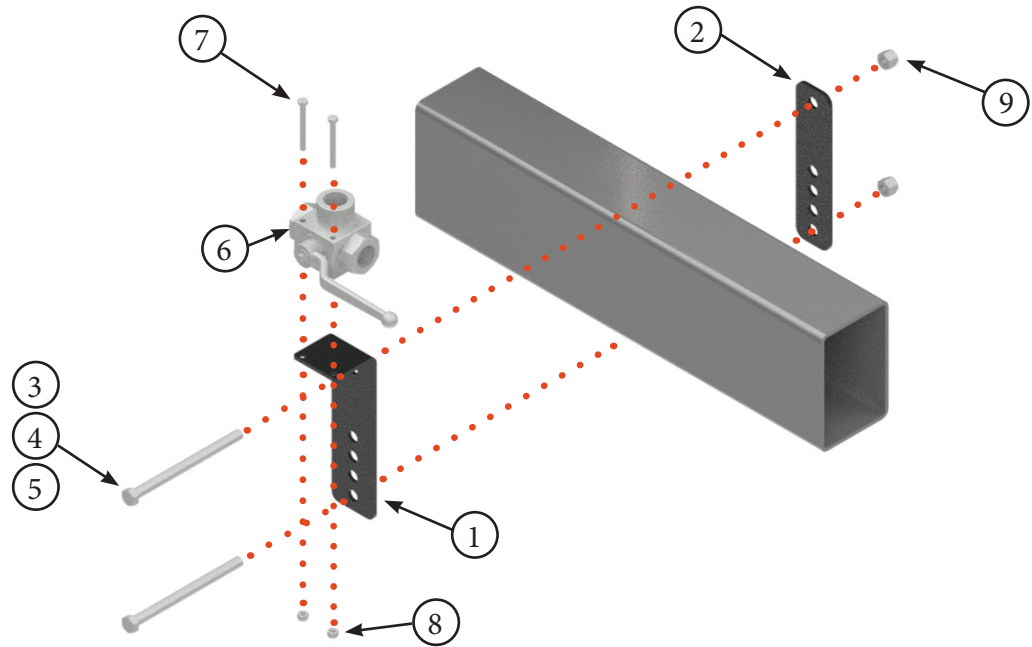

NOTE: All of the hydraulic connections in Steps 8 to 16 should only be hand tightened until all hoses and fittings are installed. Some connections may need to be rotated in order to install other components.

| PARTS LIST | | |
|------------|--------|------------------------------------|
| Item | Part # | Description |
| 1 | 7733 | Bypass Valve Mount Plate |
| 2 | 7734 | Bypass Valve Mount Back Plate |
| 3 | 7862 | HEX BOLT, 12 mm x 110mm, GRADE 8.8 |
| 4 | 7863 | HEX BOLT, 12 mm x 130mm, GRADE 8.8 |
| 5 | 7864 | HEX BOLT, 12 mm x 160mm, GRADE 8.8 |

| PARTS LIST | | |
|------------|--------|--------------------------------|
| Item | Part # | Description |
| 6 | 7274 | 3 Way Valve - 3/4" |
| 7 | 7735 | HEX BOLT, 6mm x 60mm GRADE 8.8 |
| 8 | 7736 | LOCK NUT, 6mm, GRADE 8.8 |
| 9 | 7669 | LOCK NUT, 12mm, GRADE 8.8 |

| | | | |
|--------------|---|---------------------|------------|
| Title | Airguard Bypass Kit Instructions | RELEASE DATE | 2024-04-11 |
| STEP | 9. Attach the fan return line (Item 2) to the common port on the valve (Item 5) using hydraulic hose from Blockage Prevention System (Item 3) and adapters (Item 1 & 4) to make the connection. | REV # | 2.0 |
| | | PART KIT # | Varies |

MODEL SPECIFIC CONNECTION

Aircart Models:
with 5/8" JIC
Return Hose
Connections

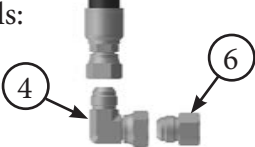

Aircart Models:
with 3/4" JIC
Return Hose
Connections

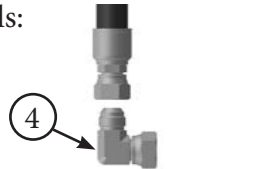

Aircart Models:
with 3/4" ORFS
Return Hose
Connections

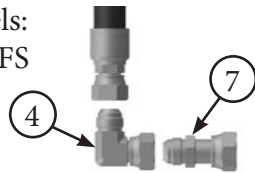
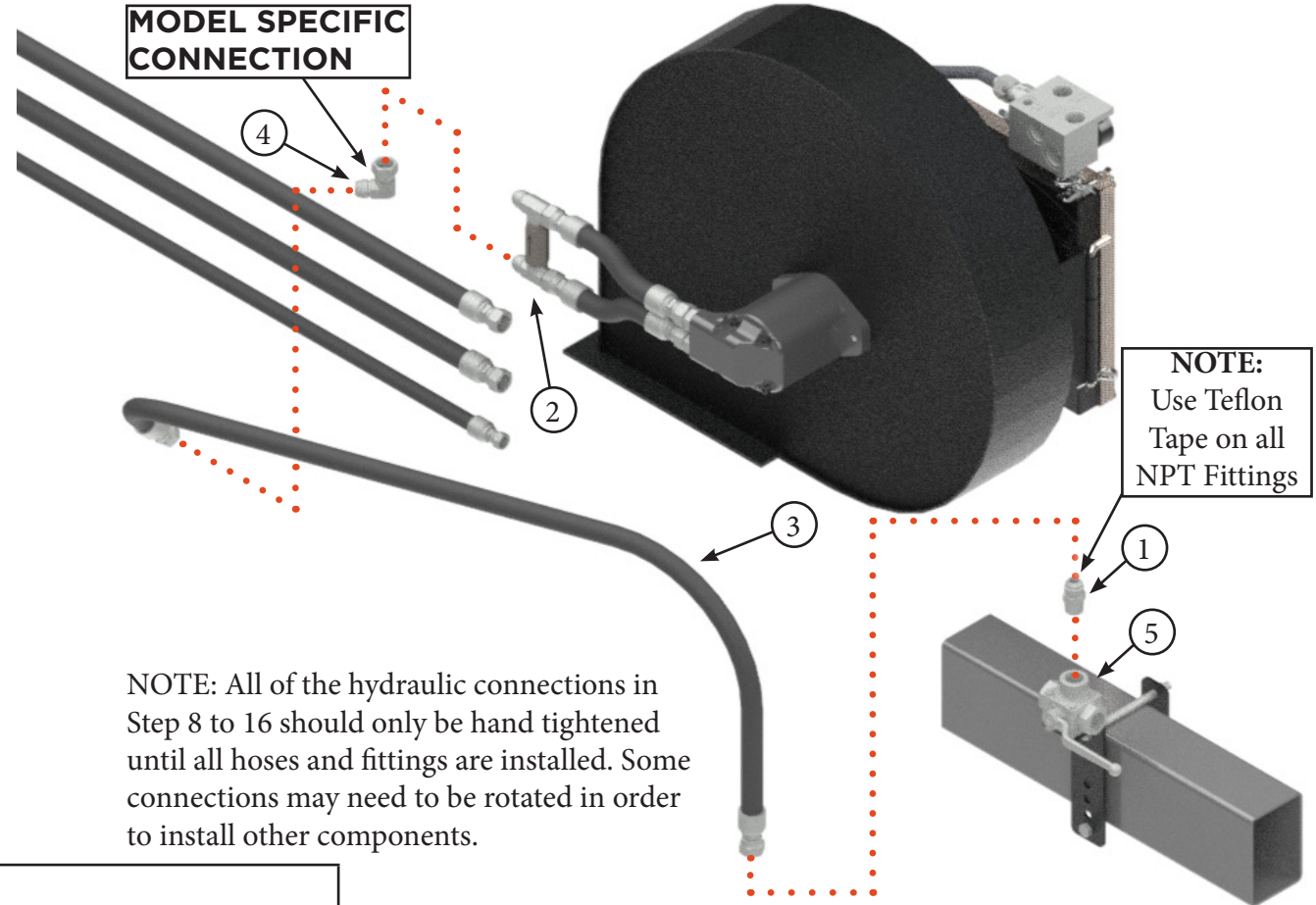
| PARTS LIST | | |
|------------|--------|--|
| Item | Part # | Description |
| 1 | 7254 | Fitting - Straight - 3/4" JIC M - 3/4" NPT M |
| 2 | ---- | Fan Return Line |
| 3 | 9016 | BPS Hydraulic Hose - 60" |
| 4 | 7539 | Fitting - Elbow - 3/4" JIC M - 3/4" JIC F |
| 5 | 7274 | 3 Way Valve - 3/4" |

| PARTS LIST | | |
|------------|--------|---|
| Item | Part # | Description |
| 6 | 7226 | Fitting - Straight - 3/4" JIC M - 5/8" JIC F |
| 7 | 7588 | Fitting - Straight - 3/4" JIC M - 3/4" ORFS F |

| | | | |
|--------------|--|---------------------|------------|
| Title | Airguard Bypass Kit Instructions | RELEASE DATE | 2024-04-11 |
| STEP | 10. Attach supplied hose (Item 2) from right valve port (Item 5) to fan return port on Blockage Prevention System manifold. Use adapters (1, 3 & 4) to make the connections. | REV # | 2.0 |
| | | PART KIT # | Varies |

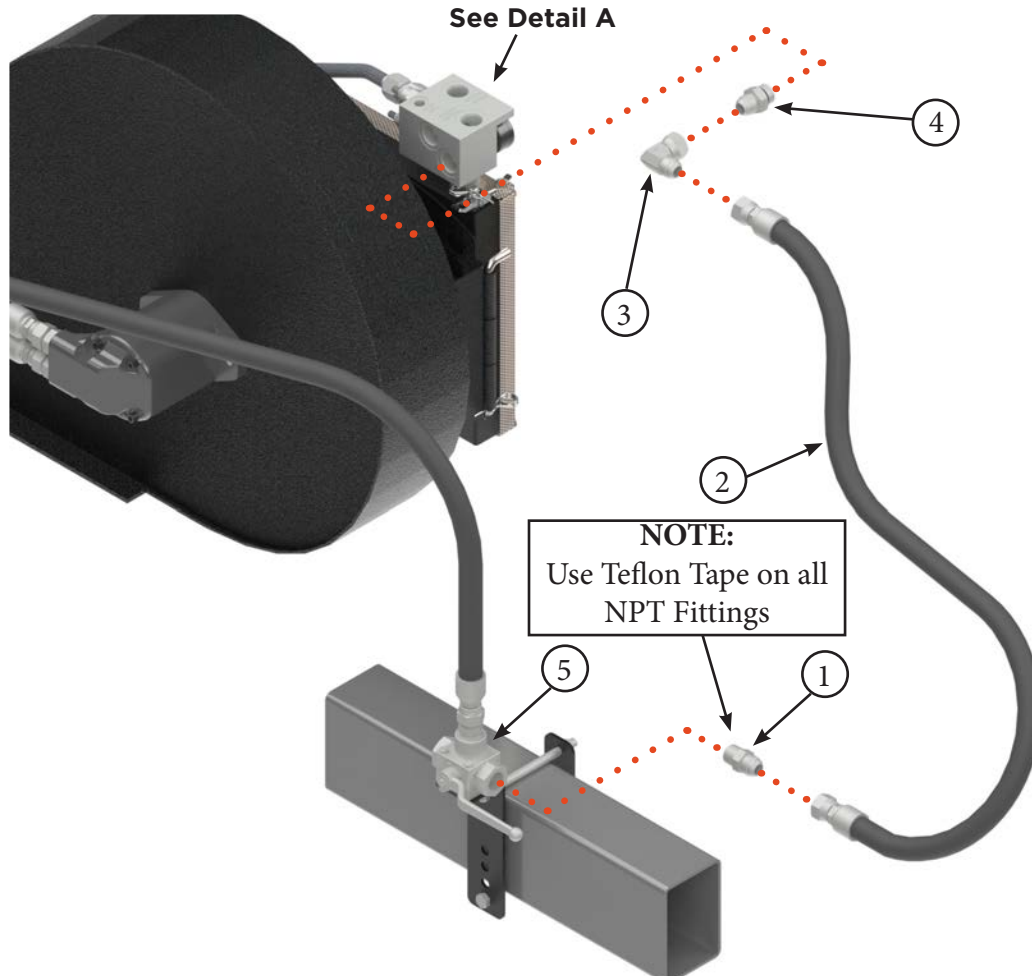

NOTE: All of the hydraulic connections in Step 8 to 16 should only be hand tightened until all hoses and fittings are installed. Some connections may need to be rotated in order to install other components.

Remove Plastic Plugs prior to installation

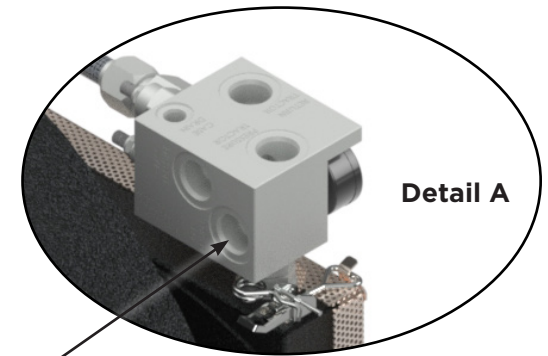

FAN RETURN PORT

| PARTS LIST | | |
|------------|--------|--|
| Item | Part # | Description |
| 1 | 7254 | Fitting - Straight - 3/4" JIC M - 3/4" NPT M |
| 2 | 9016 | BPS Hydraulic Hose - 60" |
| 3 | 7506 | Fiting - Elbow - 3/4" JIC Male - 3/4" ORB Male |

| PARTS LIST | | |
|------------|--------|--|
| Item | Part # | Description |
| 4 | 7543 | Fitting - Straight - 3/4" JIC Male - 3/4" ORB Male |
| 5 | 7274 | 3 Way Valve - 3/4" |

| | | | |
|--------------|--|---------------------|------------|
| Title | Airguard Bypass Kit Instructions | RELEASE DATE | 2024-04-11 |
| STEP | 11. Attach Tee-fitting (Item 1) to left port on bypass valve (Item 5) using adapter (Item 3). Attach supplied hose (Item 2) from Tee-fitting (Item 1) to tractor return port using adapter (Item 4). | REV # | 2.0 |
| | | PART KIT # | Varies |

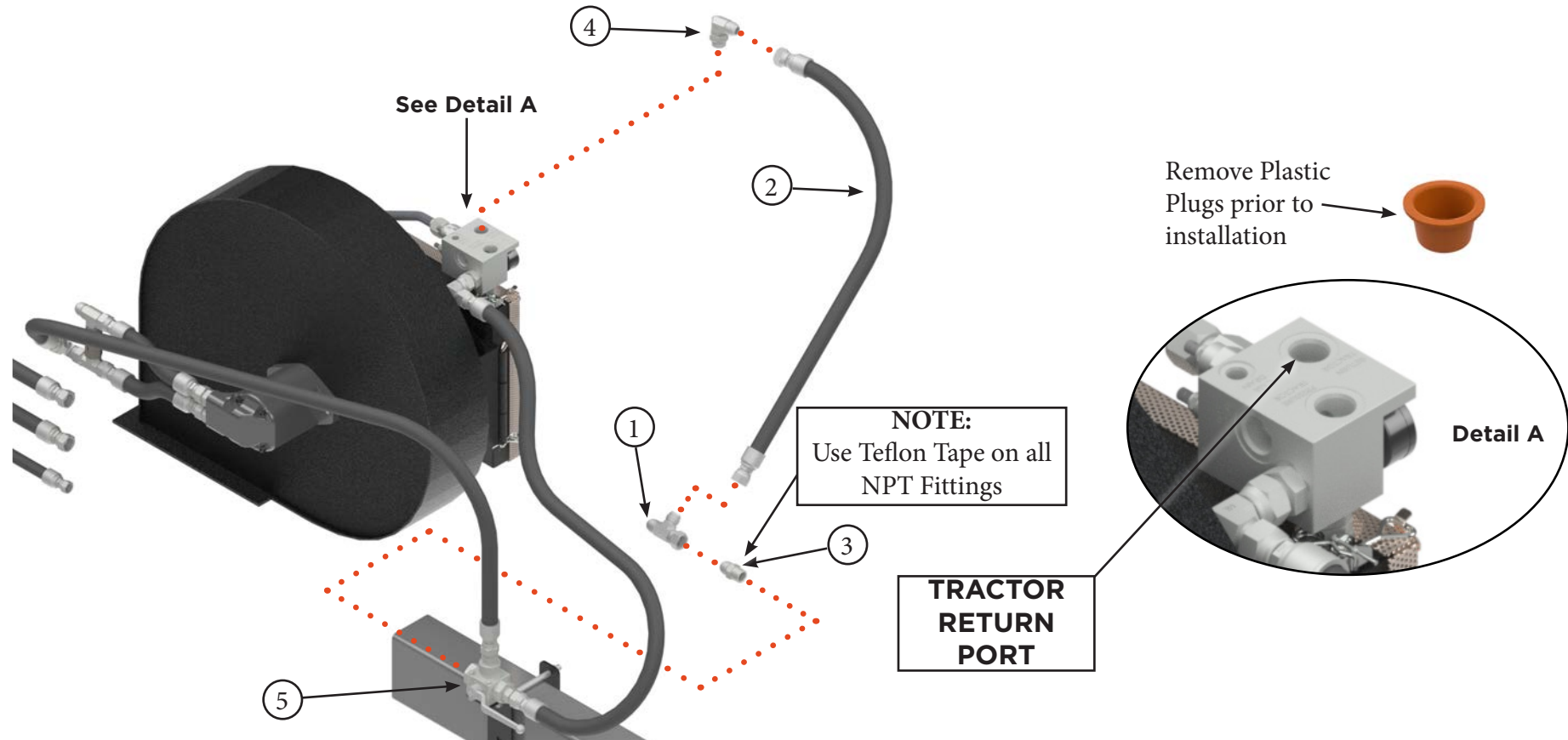

| PARTS LIST | | |
|------------|--------|---|
| Item | Part # | Description |
| 1 | 7551 | Fitting - Tee - 3/4" JIC M - 3/4" JIC M - 3/4" JIC F Swivel |
| 2 | ---- | Tractor Return Hydraulic Hose |
| 3 | 7254 | Fitting - Straight - 3/4" JIC M - 3/4" NPT M |
| 4 | 7506 | Fiting - Elbow - 3/4" JIC Male - 3/4" ORB Male |
| 5 | 7274 | 3 Way Valve - 3/4" |

NOTE: All of the hydraulic connections in Step 8 to 16 should only be hand tightened until all hoses and fittings are installed. Some connections may need to be rotated in order to install other components.

| | | | |
|--------------|--|---------------------|------------|
| Title | Airguard Bypass Kit Instructions | RELEASE DATE | 2024-04-11 |
| STEP | 12. Use model specific connection as per instructions below to attach the tractor return line (Item 2) to the bypass valve tee (Item 1). | REV # | 2.0 |
| | | PART KIT # | Varies |

NOTE: All of the hydraulic connections in Step 8 to 16 should only be hand tightened until all hoses and fittings are installed. Some connections may need to be rotated in order to install other components.

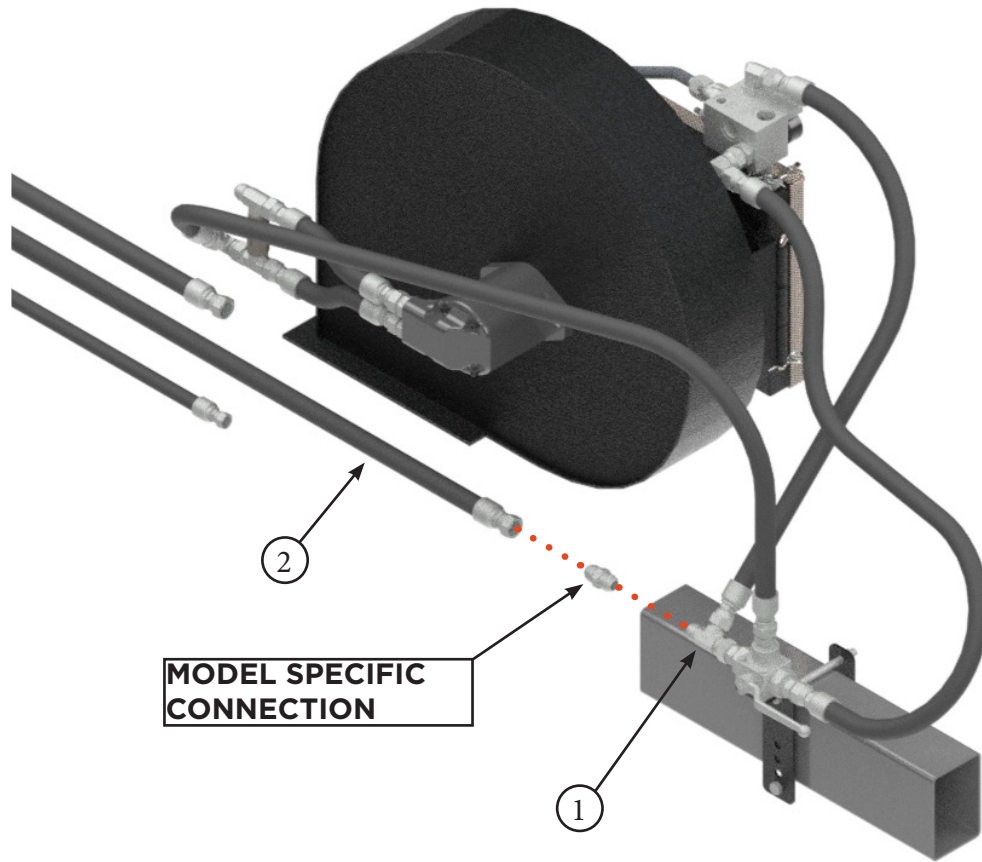

MODEL SPECIFIC CONNECTION

Aircart Models:
with 5/8" JIC Return Hose
Connections

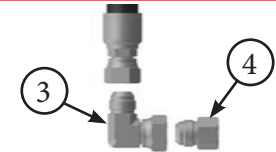

Aircart Models:
with 3/4" JIC Return Hose
Connections

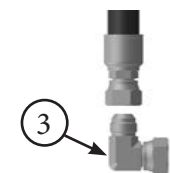

Aircart Models:
with 3/4" ORFS Return Hose
Connections

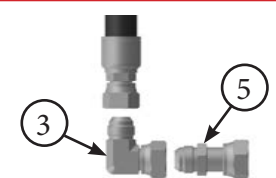

| PARTS LIST | | |
|------------|--------|---|
| Item | Part # | Description |
| 1 | 7551 | Fitting - Tee - 3/4" JIC M - 3/4" JIC M - 3/4" JIC F Swivel |
| 2 | ---- | Tractor Return Line |

| PARTS LIST | | |
|------------|--------|---|
| Item | Part # | Description |
| 3 | 7539 | Fitting - Elbow - 3/4" JIC M - 3/4" JIC F |
| 4 | 7226 | Fitting - Straight - 3/4" JIC M - 5/8" JIC F |
| 5 | 7588 | Fitting - Straight - 3/4" JIC M - 3/4" ORFS F |

| | | | |
|--------------|--|---------------------|------------|
| Title | Airguard Blockage Prevention System Upgrade Instructions | RELEASE DATE | 2024-04-11 |
| STEP | 13. Hoses may be routed to suit your specific aircart installation. Install supplied 3/4" hydraulic hose (Item 1) to the "TRACTOR PRESSURE" port of the radiator block (Item 2), using adapter (Item 3) to make the connection. Use model specific connection as per instructions below to attach the other end of the hose to the factory pressure line (Item 4) that was removed from the fan motor. | REV # | 2.0 |
| | | PART KIT # | Varies |

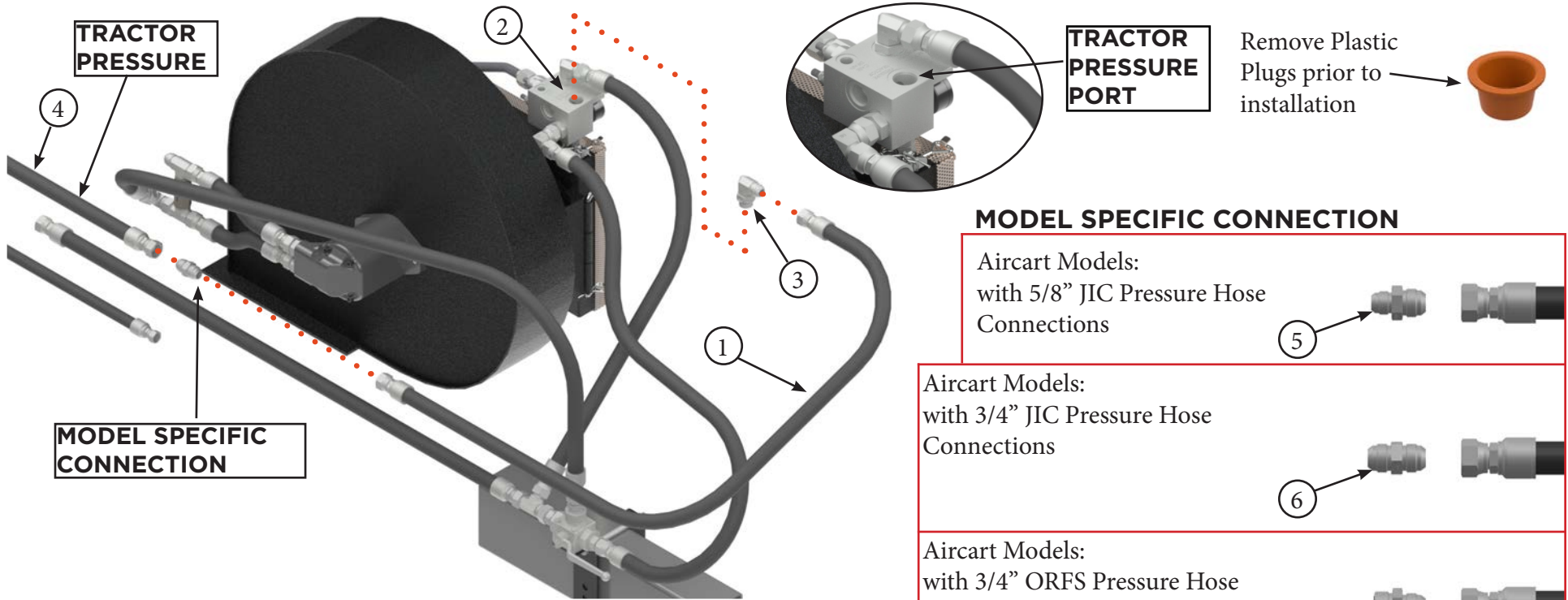

NOTE: All of the hydraulic connections in Step 8 to 16 should only be hand tightened until all hoses and fittings are installed. Some connections may need to be rotated in order to install other components.

| PARTS LIST | | |
|------------|--------|--|
| Item | Part # | Description |
| 1 | 9016 | BPS 3/4" Hydraulic Hose - 60" |
| 2 | -- | "TRACTOR PRESSURE" Port - BP System Manifold |
| 3 | 7506 | Fiting - Elbow - 3/4" JIC Male - 3/4" ORB Male |
| 4 | -- | Tractor Supply (Pressure) Hydraulic Hose |

| PARTS LIST | | |
|------------|--------|---|
| Item | Part # | Description |
| 5 | 7242 | Fitting - Straight - 5/8" JIC M - 3/4" JIC M |
| 6 | 7538 | Fitting - Straight - 3/4" JIC M - 3/4" JIC M |
| 7 | 7209 | Fitting - Straight - 3/4" JIC M - 3/4" ORFS M |

| | | | |
|--------------|--|---------------------|------------|
| Title | Airguard Blockage Prevention System Upgrade Instructions | RELEASE DATE | 2024-04-11 |
| STEP | 14. Install supplied 3/4" hydraulic hose (Item 1) to the "FAN PRESSURE" port of the radiator block (Item 2) using adapter (Item 3). Use model specific connection as per instructions below to attach the other end of the hose to the factory fan pressure line/ port (Item 4) coming from the fan motor. | REV # | 2.0 |
| | | PART KIT # | Varies |

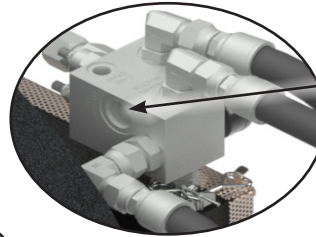
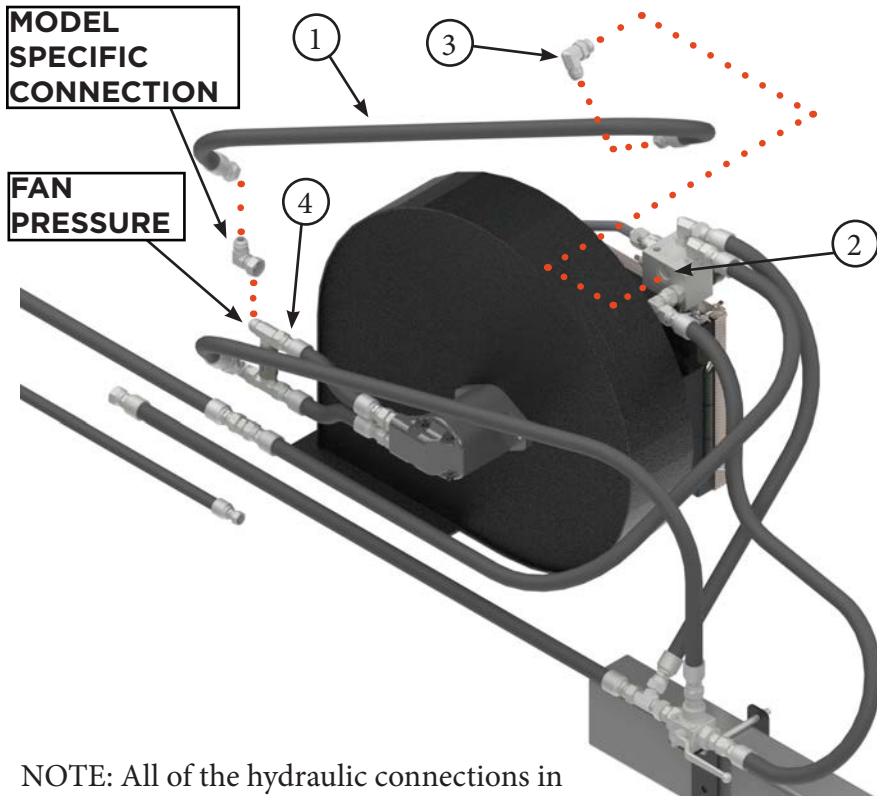

FAN PRESSURE PORT

Remove Plastic Plugs prior to installation



MODEL SPECIFIC CONNECTION

Aircart Models:
with 5/8" JIC Pressure Hose Connections

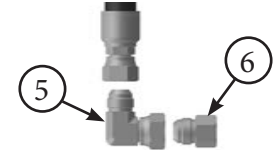

Aircart Models:
with 3/4" JIC Pressure Hose Connections

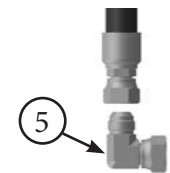

Aircart Models:
with 3/4" ORFS Pressure Hose Connections

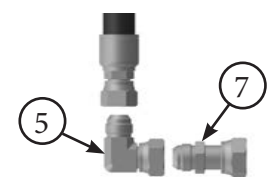

NOTE: All of the hydraulic connections in Step 8 to 16 should only be hand tightened until all hoses and fittings are installed. Some connections may need to be rotated in order to install other components.

| PARTS LIST | | |
|------------|--------|--|
| Item | Part # | Description |
| 1 | 9016 | BPS 3/4" Hydraulic Hose - 60" |
| 2 | -- | "FAN PRESSURE" Port - BP System Manifold |
| 3 | 7506 | Fiting - Elbow - 3/4" JIC Male - 3/4" ORB Male |
| 4 | -- | Fan Supply (Pressure) Hydraulic Hose |

| PARTS LIST | | |
|------------|--------|---|
| Item | Part # | Description |
| 5 | 7539 | Fitting - Elbow - 3/4" JIC M - 3/4" JIC F |
| 6 | 7226 | Fitting - Straight - 3/4" JIC M - 5/8" JIC F |
| 7 | 7588 | Fitting - Straight - 3/4" JIC M - 3/4" ORFS F |

| | | | |
|--------------|---|---------------------|------------|
| Title | Airguard Blockage Prevention System Upgrade Instructions | RELEASE DATE | 2024-04-11 |
| STEP | 15. Install supplied 1/2" hydraulic hose (Item 1) to the "CASE DRAIN" port of the radiator block (Item 2) using adapters (Item 3 & 4). and to the fan motor case drain line (Item 5). Use model specific connection as per instructions below to attach the other end of the hose to the factory fan case drain line/port (Item 5) coming from the fan motor. | REV # | 2.0 |
| | | PART KIT # | Varies |

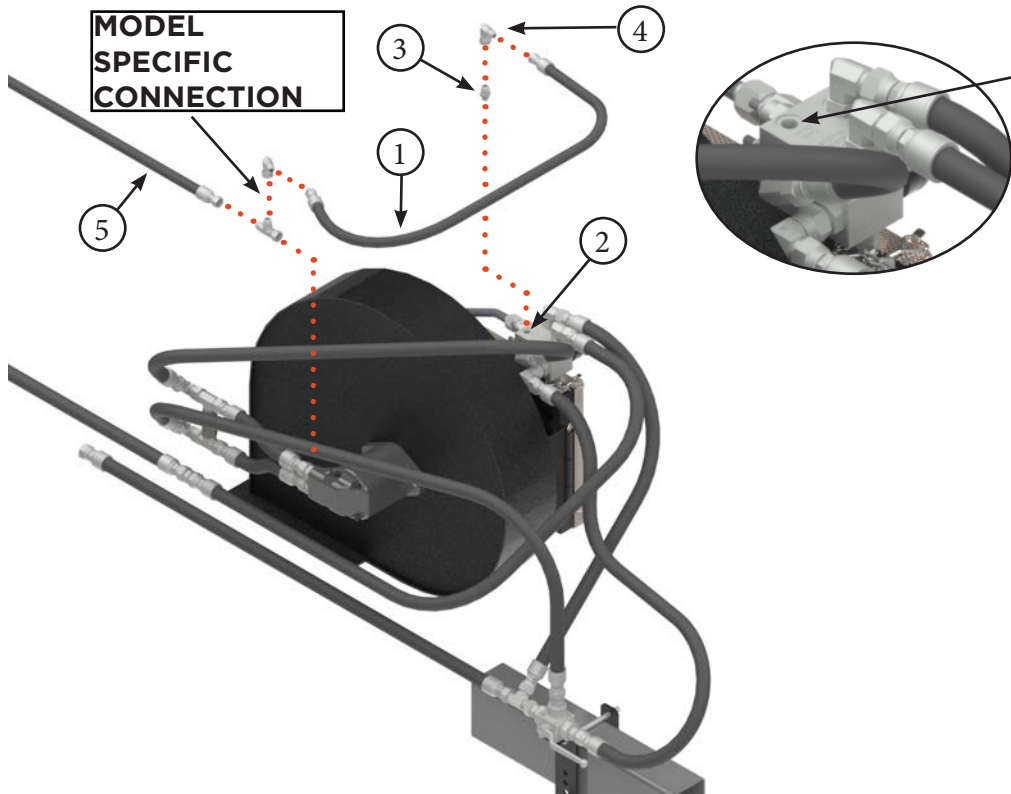

FAN CASE DRAIN PORT

Remove Plastic Plugs prior to installation



NOTE: All of the hydraulic connections in Step 8 to 16 should only be hand tightened until all hoses and fittings are installed. Some connections may need to be rotated in order to install other components.

MODEL SPECIFIC CONNECTION

Aircart Models:
with 1/2" JIC Case Drain
Hose Connections

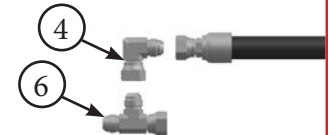

Aircart Models:
with 1/2" ORFS Case Drain
Hose Connections

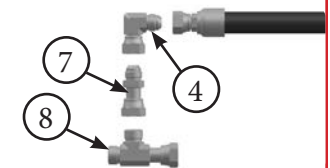

| PARTS LIST | | |
|------------|--------|--|
| Item | Part # | Description |
| 1 | 7267 | BPS 1/2" Hydraulic Hose - 60" |
| 2 | -- | "FAN CASE DRAIN" Port - BP System Manifold |
| 3 | 7264 | Fitting - Straight - 1/2" JIC Male - 3/8" ORB Male |
| 4 | 7686 | Fiting - Elbow - 1/2" JIC M - 1/2" JIC F |
| 5 | -- | Fan Case Drain Hydraulic Hose |

| PARTS LIST | | |
|------------|--------|---|
| Item | Part # | Description |
| 6 | 7263 | Fitting - Tee - 1/2" JIC M - M - F |
| 7 | 7265 | Fitting - Straight - 1/2" JIC M - 1/2" ORFS F |
| 8 | 7266 | Fitting - Tee - 1/2" ORFS M - M - F |

| | | | |
|--------------|--|---------------------|------------|
| Title | Airguard Bypass Kit Instructions | RELEASE DATE | 2024-04-11 |
| STEP | 16. This shows the complete installation. It is recommended to put the valve in the off position when starting up for the first time and also at the beginning of the season to ensure that all air pockets are removed prior to operation. It also gives a chance for the oil to warm up prior to using the BP System. Valve can be slowly opened on startup to remove all air pockets. | REV # | 2.0 |
| | | PART KIT # | Varies |

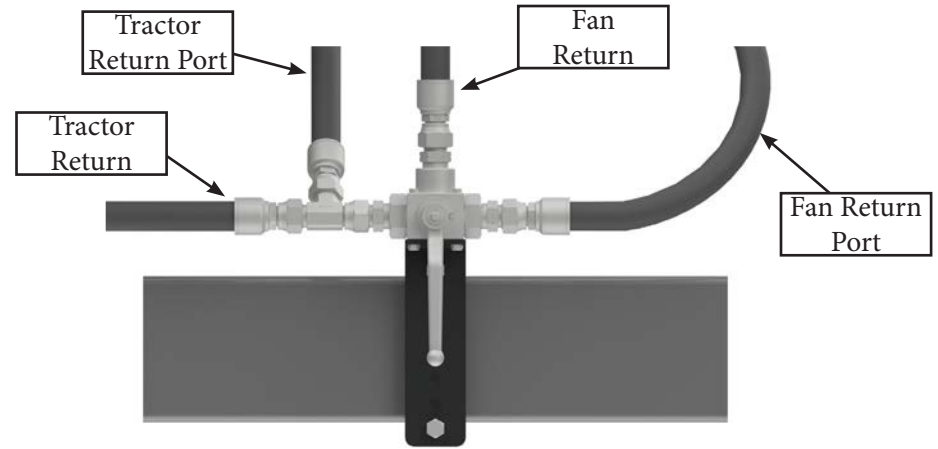
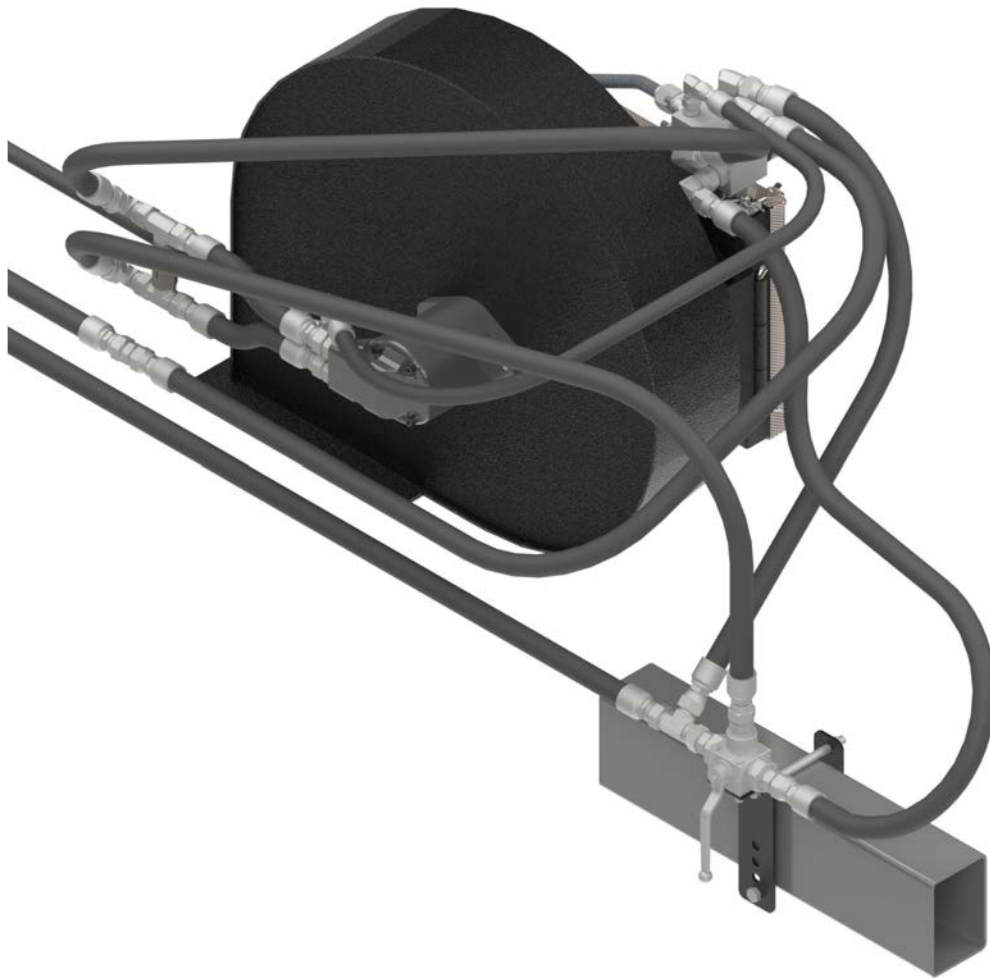

OIL THROUGH COOLER
(BP System "ON" State)

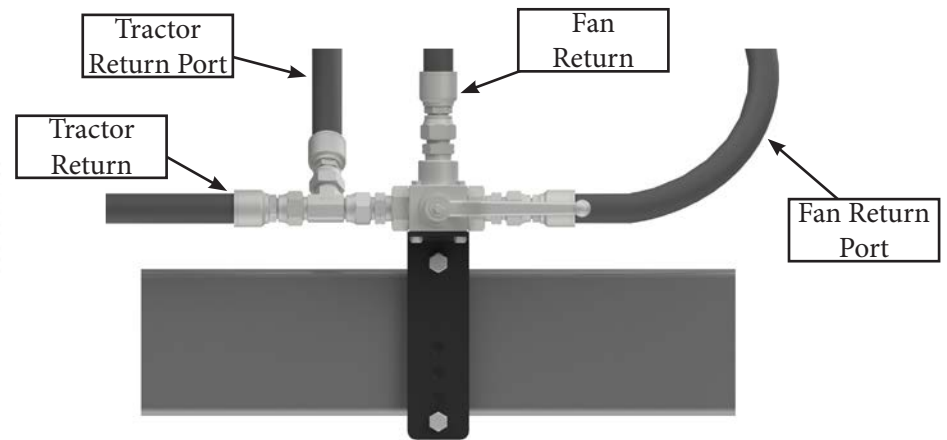

OIL BYPASS COOLER
(BP System "OFF" State)

| | | | |
|--------------|--|---------------------|------------|
| Title | Airguard Blockage Prevention System Upgrade Instructions | RELEASE DATE | 2024-04-11 |
| STEP | 17. Complete the hydraulic installation by ensuring that all connections made in Step 8 to 13 are tightened. Position/Routing of hydraulic hoses may vary to suit each specific machine installation. Zip tie hoses to reduce wear and ensure tidy installation. | REV # | 2.0 |
| | | PART KIT # | Varies |

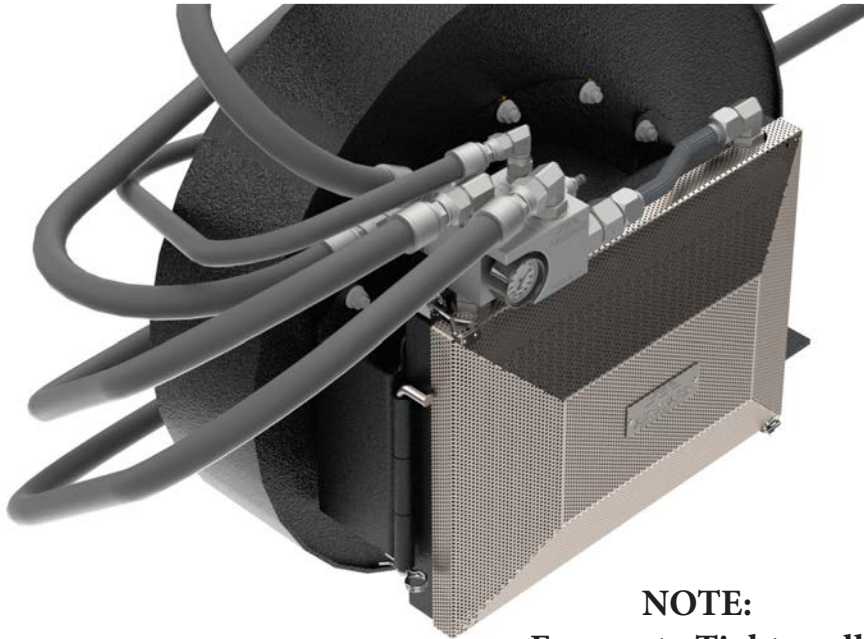

NOTE:
Ensure to Tighten all Hydraulic Connections

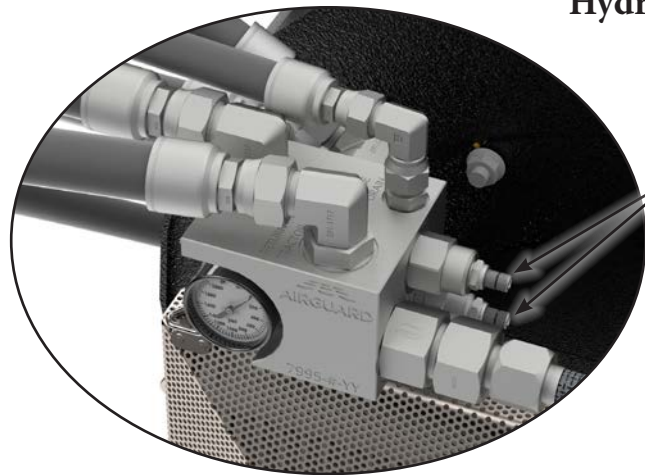

**DO NOT
 ADJUST
 VALVES**

WARNING:

- Check for contaminants in oil. Dirty oil makes for plugged valves and can cause issues with over pressurizing the radiator core.
- Start tractor and warm oil prior to starting up fan. This should be done anytime the fan circuit is started up.
- Engage fan hydraulics at low flow rate and low fan RPM and slowly increase.
- Bleed hydraulic lines of air for stable oil flow.
- Check pressures at radiator gauge. If pressure is higher than normal, steps must be taken to reduce return line pressure.
- Call Airguard if you have any questions. 1-604-744-0070

| | | | |
|-------|--|--------------|------------|
| Title | Airguard Blockage Prevention System Upgrade Instructions | RELEASE DATE | 2024-04-11 |
| STEP | 18. Start up operating procedure. | REV # | 2.0 |
| | | PART KIT # | Varies |

----- WARNING -----

Start up procedure is critical to reduce pressure spikes.

START UP PROCEDURE:

After you have installed the Airguard Blockage Prevention System it's critical that you start the Aircart fans very slowly. You're introducing an air pocket that must be moved slowly to the tractor while you prime the hydraulic lines with oil. This process is a good way to make sure your fittings are sealed and secure.

1. Get your oil warmed to 80-100 deg F. If your oil is cold, the viscosity is very high and it will not move through the internal components easily. By warming the oil first, everything will operate as it should.
2. Initiate your fans with 500 Fan RPM at 25% oil flow (or 10% of your max fan speed). If everything looks good, the pressure is just starting to register on the Airguard pressure gauge. If all your fittings are holding their seal, continue to the next step. If your fan is NOT moving, that's okay. The oil is circulating.
Operate this way for 5 minutes.

NOTE: If there is a pressure spike at this low oil flow rate, there is potential for an air lock. Disconnect the end fitting on the Return Line at the SCV and drain off some oil to release the pressure. Reconnect the end fitting and repeat Step 2.

3. Run 1000 Fan RPM at 45% oil flow (or 35% of your max fan speed). Operate for 5 seconds.
4. Run 2000 Fan RPM at 65% oil flow (or 75% of your max fan speed). Operate for 5 seconds.
5. Run 3500 Fan RPM at 85% oil flow (or 100% of your max fan speed). Operate for 3-5 minutes.
6. Take time to ensure that your conveyor or auger is working properly in conjunction with your Airguard kit. Turn your fan RPM down to 50% oil flow and engage the conveyor/auger. If everything is operating as it should, you have successfully installed your Airguard Blockage Prevention System kit. If there are any questions or concerns about the operations, call your AIRGUARD Sales Representative using contact information found at www.airguardproducts.com/contact or visit us at www.airguardproducts.com/productsupport.

Now you're ready to operate! Follow the same warm up procedure you do every day and go seed. This is a procedure that we highly recommend at the beginning of each future season, to ensure the continuation of successful operations. It is a critical step in the introduction of new machinery to your farm operation. After the freeze and thaw of seasons we want to eliminate any air pockets or leaks that could slow preparations.

| | | | |
|--------------|---|---------------------|------------|
| Title | Airguard Blockage Prevention System Upgrade Instructions | RELEASE DATE | 2024-04-11 |
| STEP | 19. There are three ways to mount the Snorkel Kit. It can be mounted directly to the catwalk (Page 21), to the railing (Page 22), or using the model-specific Snorkel Mounting Kit (Pages 23-29). | REV # | 2.0 |
| | | PART KIT # | Varies |

CATWALK



RAILING



SNORKEL MOUNTING KIT

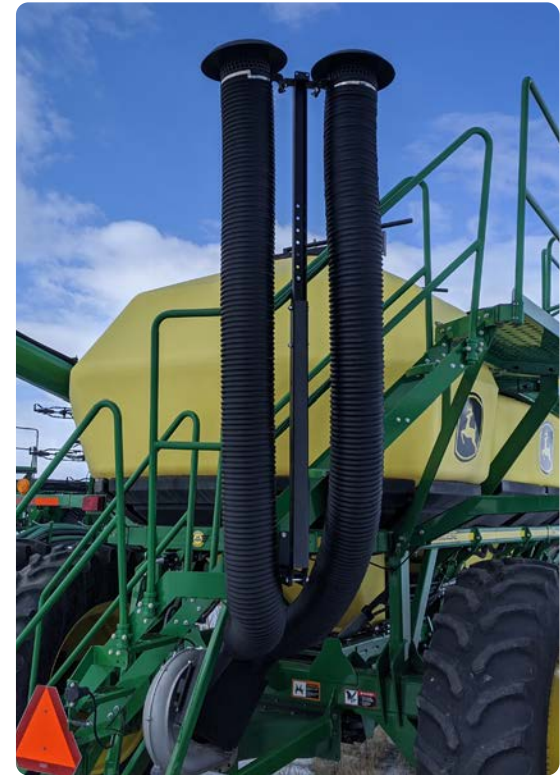

THREE SNORKEL MOUNTING OPTIONS

| | | | |
|--------------|--|---------------------|------------|
| Title | Airguard Blockage Prevention System Upgrade Instructions | RELEASE DATE | 2024-04-11 |
| STEP | 20. Catwalk Installation: Drill two 7/16” holes in your catwalk (Item 2) 1-3/4” apart. Using the two bolts (Item 3) and lock nuts (Item 4) provided, bolt the top Snorkel Inlet Assembly (Item 1) directly to the catwalk. Use the bridge clamp (Item 5) to attach 8” flexible hose (Item 6) to top Snorkel Inlet (Item 1). | REV # | 2.0 |
| | | PART KIT # | Varies |

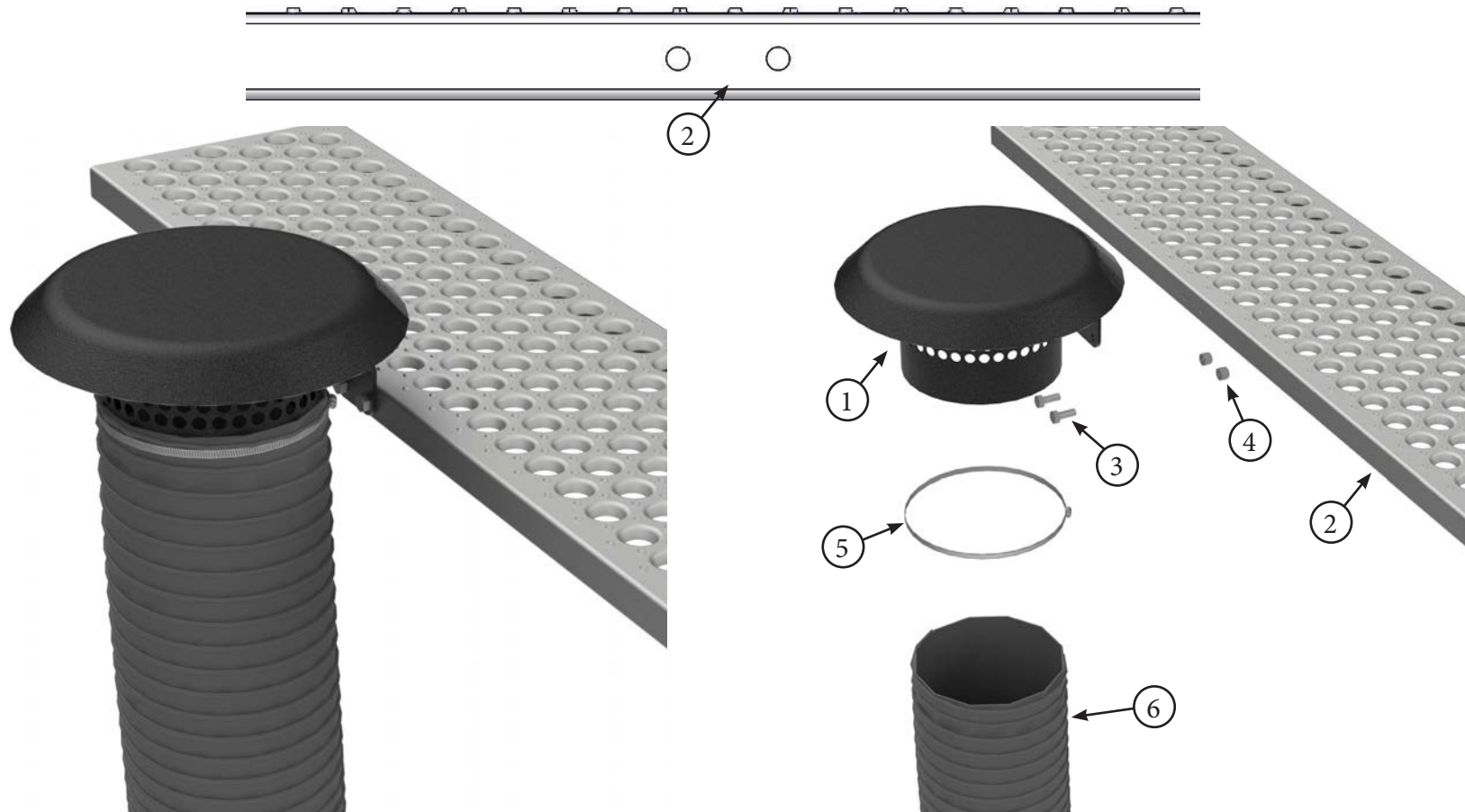

| PARTS LIST | | |
|------------|--------|---------------------------------|
| Item | Part # | Description |
| 1 | 7576 | Top Snorkel Inlet Assembly |
| 2 | ---- | Catwalk |
| 3 | 7515 | Hex Bolt, 10mm x 25mm GRADE 8.8 |

| PARTS LIST | | |
|------------|--------|----------------------------|
| Item | Part # | Description |
| 4 | 7516 | Lock Nut, 10mm GRADE 8.8 |
| 5 | 7578 | Bridge Clamp, 8” |
| 6 | 7572 | Flexible Snorkel Hose - 8” |

| | | | |
|--------------|---|---------------------|------------|
| Title | Airguard Blockage Prevention System Upgrade Instructions | RELEASE DATE | 2024-04-11 |
| STEP | 21. Railing Installation: Using two of the bolts (Item 4) and lock nuts (Item 5) provided, hand-tighten the Snorkel Inlet 90deg mount plate (Item 2) and the railing plate (Item 3) around the railing (Item 8). Next, bolt the top Snorkel Inlet assembly (Item 1) to the mount plate (Item 2). Straighten so that the assembly is perpendicular to the railing, then fully tighten. Last, use the bridge clamp (Item 6) to attach 8” flexible hose (Item 7) to top Snorkel Inlet (Item 1). | REV # | 2.0 |
| | | PART KIT # | Varies |

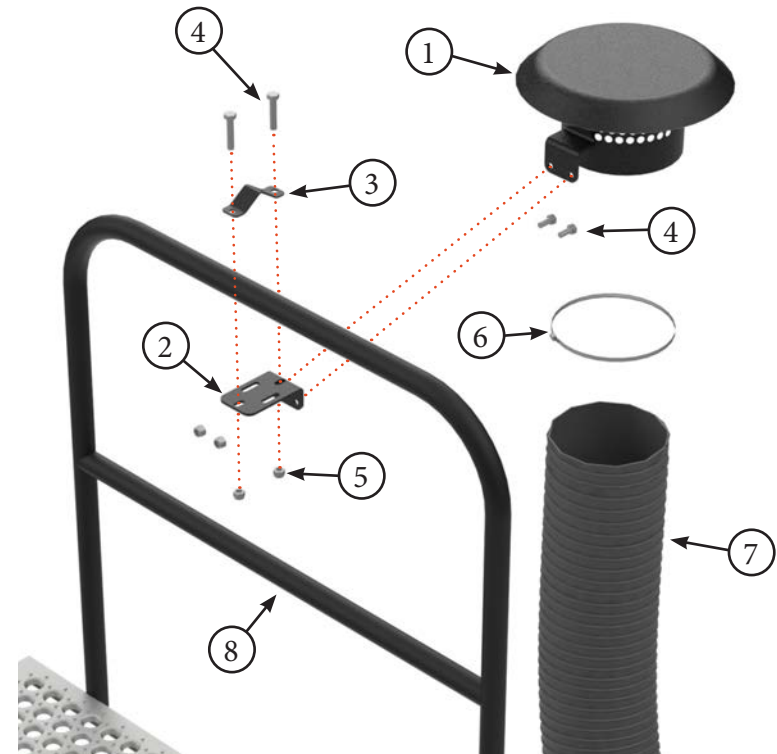

| PARTS LIST | | |
|------------|--------|---------------------------------|
| Item | Part # | Description |
| 1 | 7576 | Top Snorkel Inlet Assembly |
| 2 | 7593 | Snorkel Inlet 90deg Mount Plate |
| 3 | 7989 | Railing Plate |
| 4 | 7991 | HEX BOLT, 10mm x 50mm GRADE 8.8 |

| PARTS LIST | | |
|------------|--------|----------------------------|
| Item | Part # | Description |
| 5 | 7516 | Lock Nut, 10mm |
| 6 | 7578 | Bridge Clamp, 8” |
| 7 | 7572 | Flexible Snorkel Hose - 8” |
| 8 | ---- | Railing |

| | | | |
|--------------|---|---------------------|------------|
| Title | Airguard Blockage Prevention System Upgrade Instructions | RELEASE DATE | 2024-04-11 |
| STEP | 22. For 1910 Aircarts. Install the bracket (Item 1) onto Fan Mount Plate (Item 2) using existing hardware (Item 3). | REV # | 2.0 |
| | | PART KIT # | Varies |

MODEL SPECIFIC CONNECTION - KIT 7940:
8600 Floater
8700 Floater

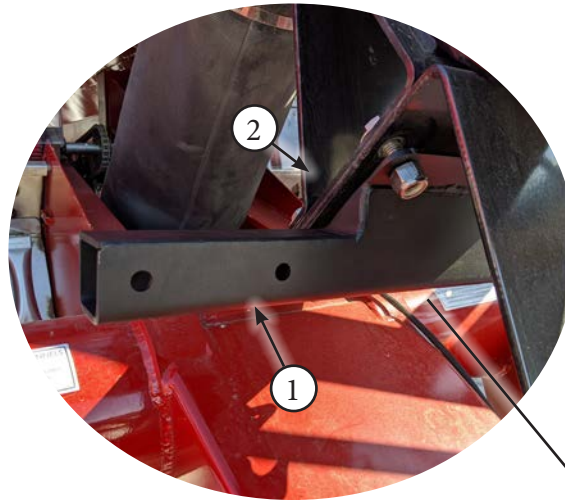
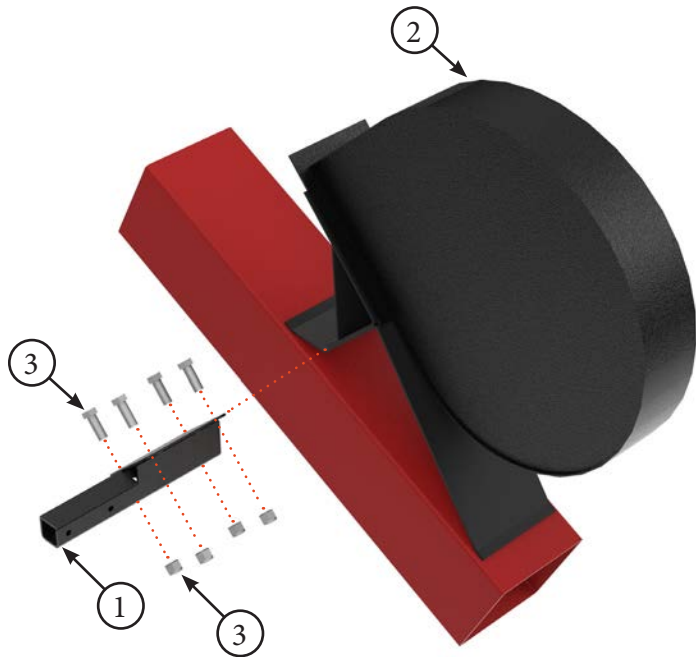

| PARTS LIST | | |
|------------|--------|-----------------|
| Item | Part # | Description |
| 1 | 7931 | Bracket |
| 2 | -- | Fan Mount Plate |

| PARTS LIST | | |
|------------|--------|-------------------|
| Item | Part # | Description |
| 3 | -- | Existing hardware |

| | | | |
|--------------|---|---------------------|------------|
| Title | Airguard Blockage Prevention System Upgrade Instructions | RELEASE DATE | 2024-04-11 |
| STEP | 23. For 9620 Floaters. Install the bracket (Item 1) onto the left bumper plate (Item 2) using 12mm x 40mm Bolts (Item 3), using 12mm Flat Washers (Item 4) and 12mm Lock Nuts (Item 5). | REV # | 2.0 |
| | | PART KIT # | Varies |

MODEL SPECIFIC CONNECTION - KIT 7950:
9620 Floater

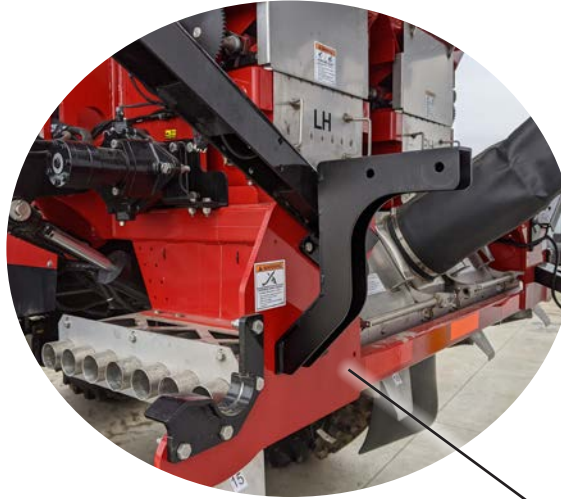
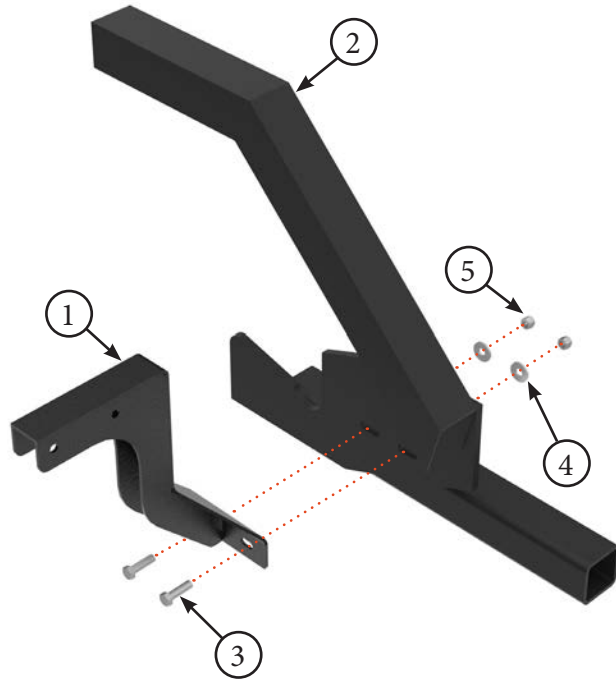

| PARTS LIST | | |
|------------|--------|-----------------------|
| Item | Part # | Description |
| 1 | 7946 | Bracket |
| 2 | -- | Left Bumper Plate |
| 3 | 7671 | Hex Bolt, 12mm x 40mm |

| PARTS LIST | | |
|------------|--------|-------------------|
| Item | Part # | Description |
| 4 | 7925 | Flat Washer, 12mm |
| 5 | 7669 | Lock Nut, 12mm |

| | | | |
|--------------|---|---------------------|------------|
| Title | Airguard Blockage Prevention System Upgrade Instructions | RELEASE DATE | 2024-04-11 |
| STEP | 24. For installations on specific models as per below, the universal snorkel mount can be used. Install the brackets (Item 1 & 2) onto Aircart HSS Frame (Item 3) using supplied hardware. Use 12mm x 30mm (Item 4) and 12mm lock nuts (Item 5) for top connection. Use 12mm x 110mm-160mm (Item 6, 7 or 8) and 12mm lock nuts (Item 5) for bottom connection. Bracket is designed to fit HSS Beams 3"-5" x 3"-10" in vertical or horizontal mount positions. | REV # | 2.0 |
| | | PART KIT # | Varies |

MODEL SPECIFIC CONNECTION - KIT 7860:

AC1000
AC2000
AC3000
3605

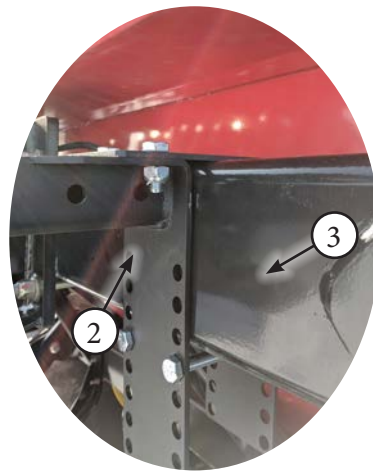
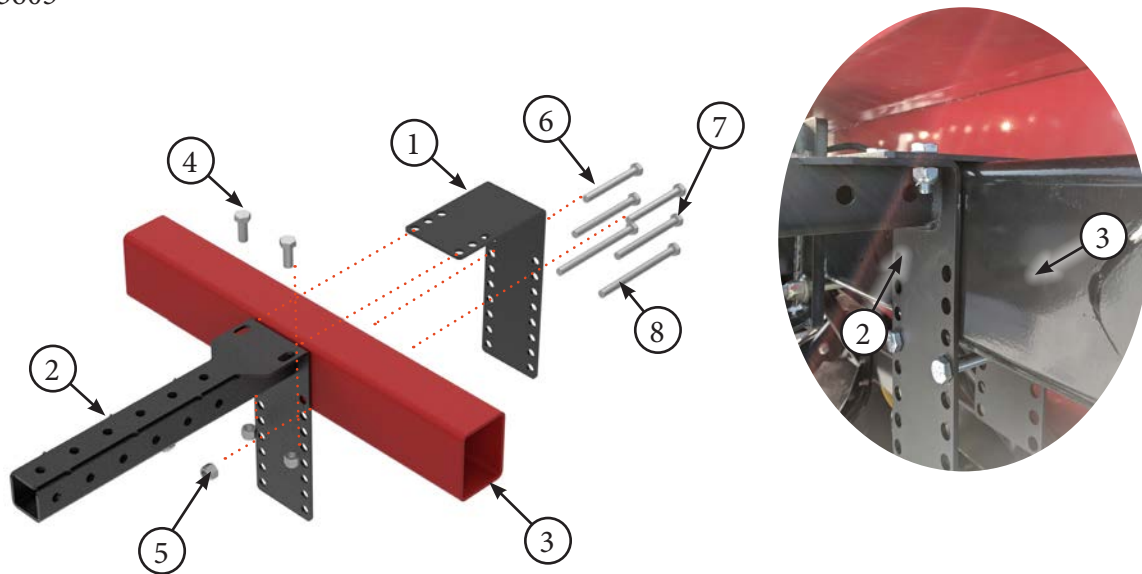

Tow Behind

| PARTS LIST | | |
|------------|--------|---------------------------------|
| Item | Part # | Description |
| 1 | 7869 | Adjustable HSS Backing Plate |
| 2 | 7873 | Adjustable HSS Bracket Assembly |
| 3 | -- | Aircart HSS Frame |
| 4 | 7861 | Hex Bolt, 12mm x 30mm |

| PARTS LIST | | |
|------------|--------|------------------------|
| Item | Part # | Description |
| 5 | 7669 | Lock Nut, 12mm |
| 6 | 7862 | Hex Bolt, 12mm x 110mm |
| 7 | 7863 | Hex Bolt, 12mm x 130mm |
| 8 | 7864 | Hex Bolt, 12mm x 160mm |

| | | | |
|--------------|---|---------------------|------------|
| Title | Airguard Blockage Prevention System Upgrade Instructions | RELEASE DATE | 2024-04-11 |
| STEP | 25. Mount outer vertical channel (Item 1) to Mount Bracket (Item 2) using supplied 12mm x 80mm Bolts (Item 3) and 12mm lock nuts (Item 4). For some installations it is easier to attach only 1 bolt and then rotate up into position after installing the upper channel, see step 18 & 19. | REV # | 2.0 |
| | | PART KIT # | Varies |

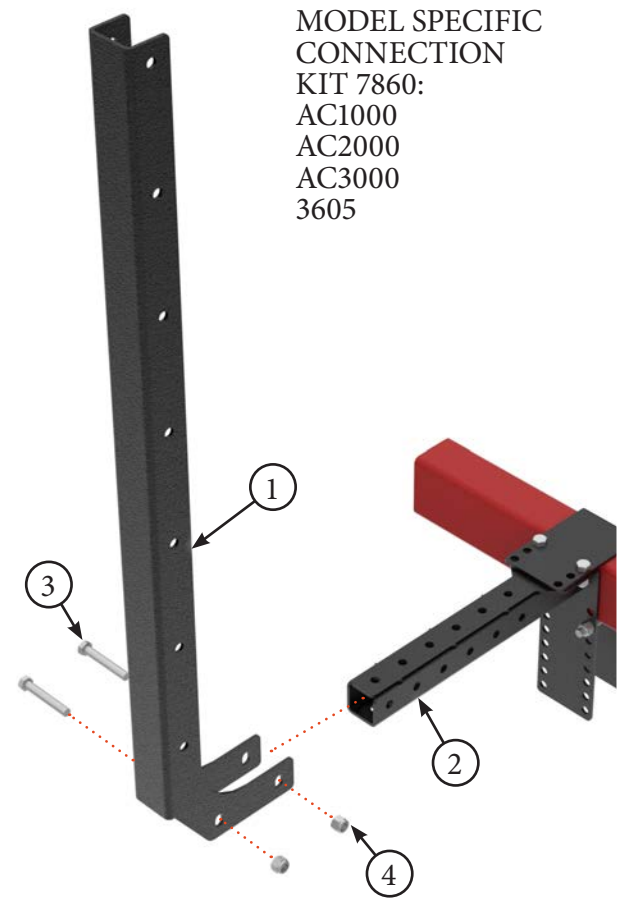
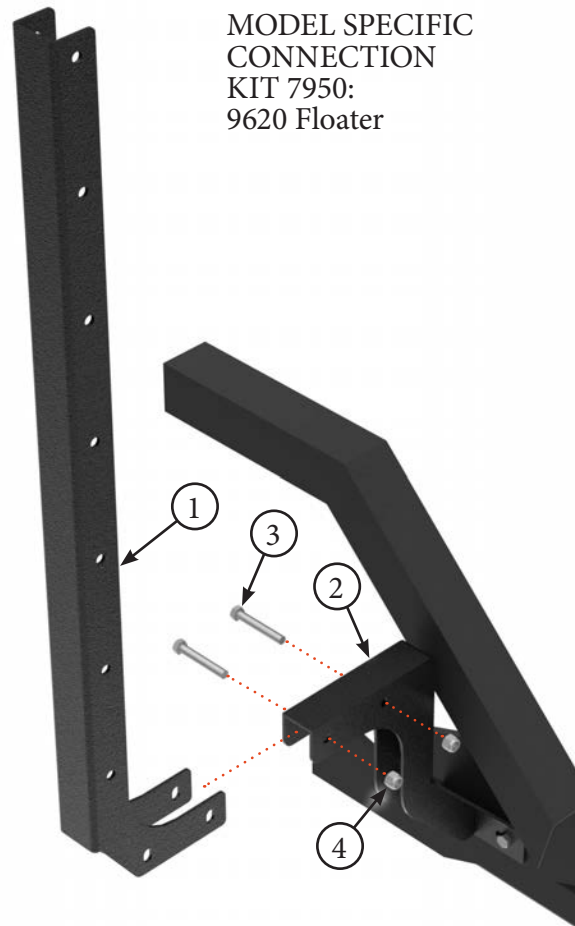
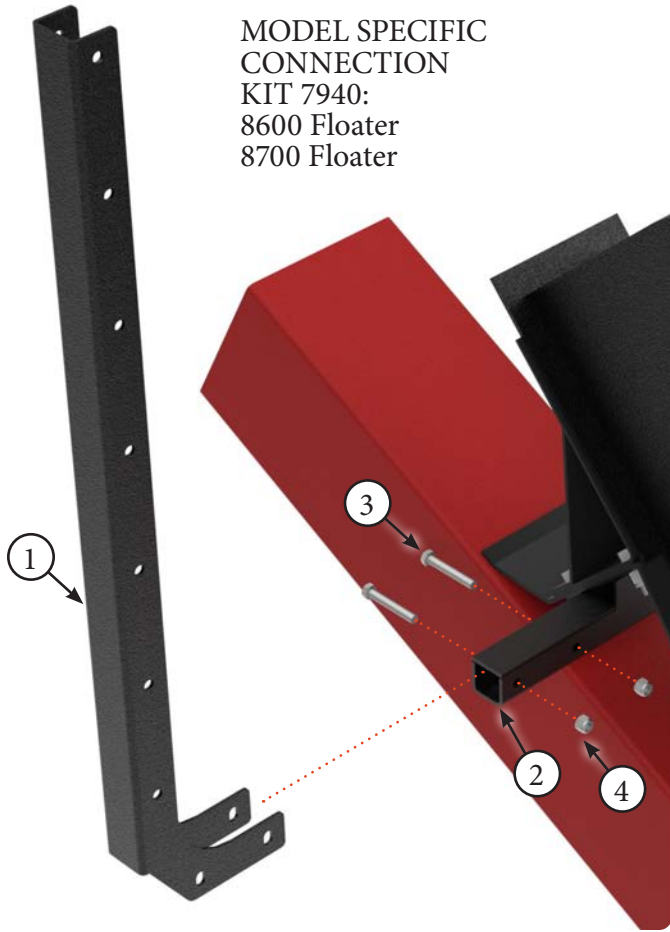

| PARTS LIST | | |
|------------|--------|------------------------|
| Item | Part # | Description |
| 1 | 7865 | Outer Vertical Channel |
| 2 | -- | Mount Bracket |

| PARTS LIST | | |
|------------|--------|-----------------------|
| Item | Part # | Description |
| 3 | 7859 | Hex Bolt, 12mm x 80mm |
| 4 | 7669 | Lock Nut, 12mm |

| | | | |
|--------------|--|---------------------|------------|
| Title | Airguard Blockage Prevention System Upgrade Instructions | RELEASE DATE | 2024-04-11 |
| STEP | 26. Attach air intakes (Item 1) to upper vertical channel (Item 2) using supplied 10mm x 25mm Bolts (Item 3) and 10mm lock nuts (Item 4). A maximum of 4 intakes can be mounted. Use bridge clamp (Item 5) to attach 8” flex hose (Item 6) to air intake (Item 1). | REV # | 2.0 |
| | | PART KIT # | Varies |

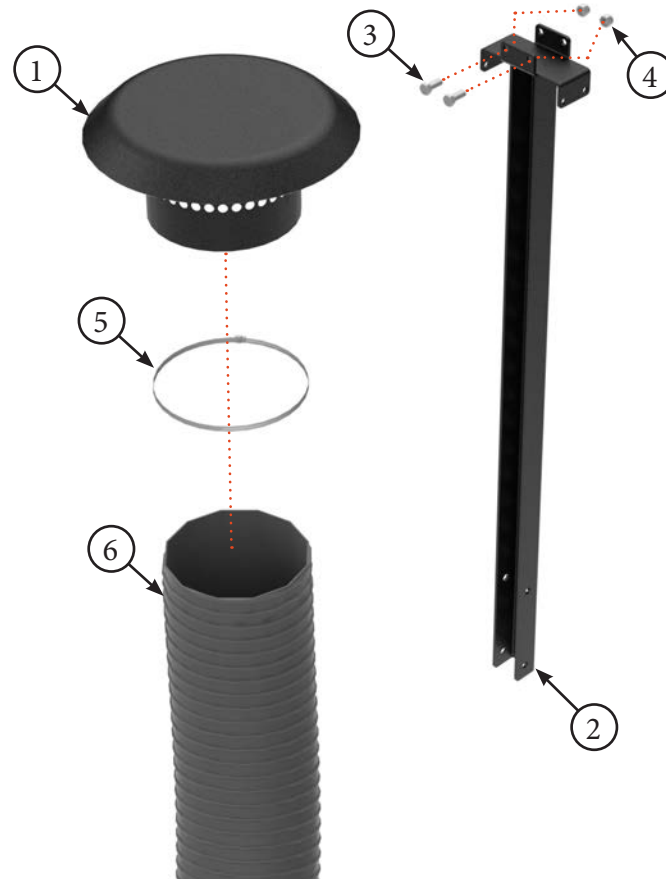

| PARTS LIST | | |
|------------|--------|------------------------|
| Item | Part # | Description |
| 1 | 7576 | Air Intake Bracket |
| 2 | 7868 | Upper Vertical Channel |
| 3 | 7515 | Hex Bolt, 10mm x 25mm |

| PARTS LIST | | |
|------------|--------|----------------------------|
| Item | Part # | Description |
| 4 | 7516 | Lock Nut, 10mm |
| 5 | 7578 | Bridge Clamp, 8” |
| 6 | 7572 | Flexible Snorkel Hose - 8” |

| | | | |
|--------------|--|---------------------|------------|
| Title | Airguard Blockage Prevention System Upgrade Instructions | RELEASE DATE | 2024-04-11 |
| STEP | 27. Determine desired height of air intakes and secure upper vertical channel (Item 1) to lower vertical channel (Item 2) at that location. Use supplied 12mm x 80mm Bolts (Item 3) and 12mm lock nuts (Item 4). For some installations it is easier to attach only 1 bolt on the lower channel and then rotate up into position after installing the upper channel. | REV # | 2.0 |
| | | PART KIT # | Varies |

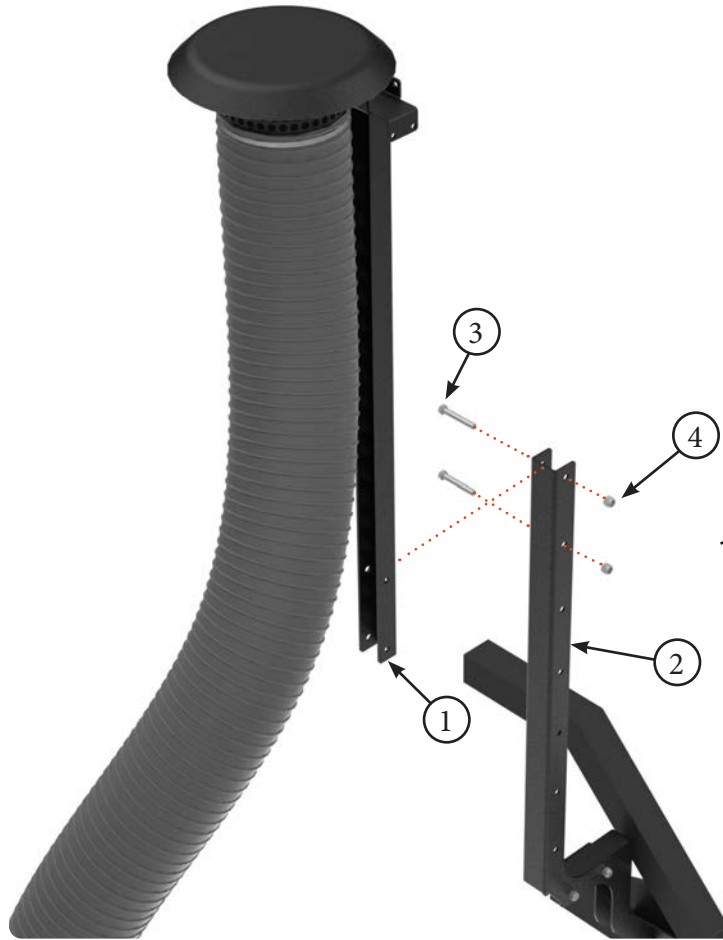

| PARTS LIST | | |
|------------|--------|------------------------|
| Item | Part # | Description |
| 1 | 7868 | Upper Vertical Channel |
| 2 | 7865 | Lower Vertical Channel |

| PARTS LIST | | |
|------------|--------|-----------------------|
| Item | Part # | Description |
| 3 | 7859 | Hex Bolt, 12mm x 80mm |
| 4 | 7669 | Lock Nut, 12mm |

| | | | |
|--------------|--|---------------------|------------|
| Title | Airguard Blockage Prevention System Upgrade Instructions | RELEASE DATE | 2024-04-11 |
| STEP | 28. For 9620 Floaters, attach stabilizer bracket (Item 1) to catwalk frame (Item 2) using supplied 3/8" x 2 1/2" Bolts (Item 3), 3/8" Flat Washers (Item 4) and 3/8" lock nuts (Item 5). Attach stabilizer bracket (Item 1) to Lower Channel (Item 6) using supplied 12mm x 90mm Bolts (Item 7) and 12mm Lock Nuts (Item 8). | REV # | 2.0 |
| | | PART KIT # | Varies |

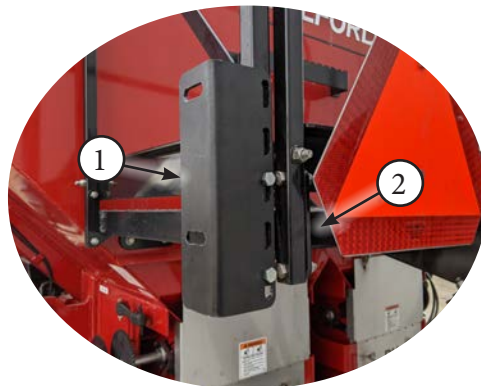
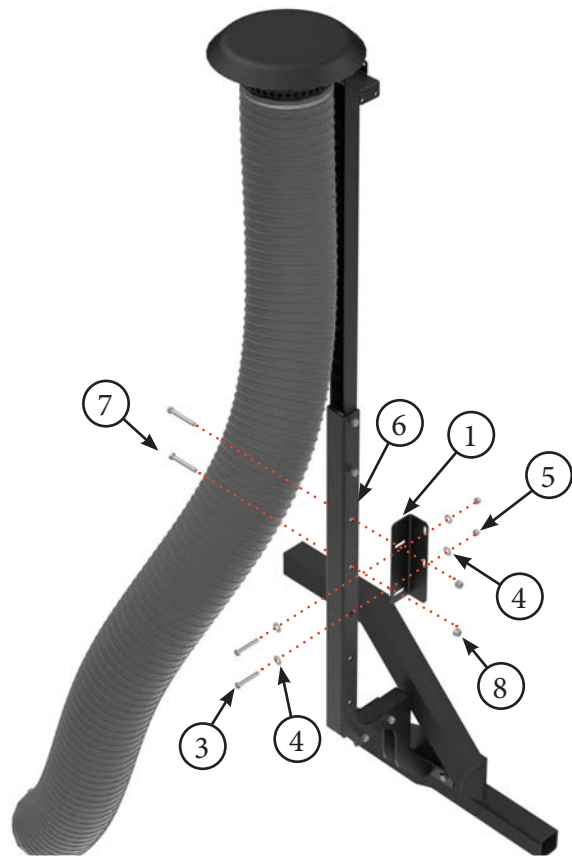

| PARTS LIST | | |
|------------|--------|-------------------------|
| Item | Part # | Description |
| 1 | 7949 | Stabilizer Bracket |
| 2 | -- | Catwalk Frame |
| 3 | 7838 | Hex Bolt, 3/8" x 2 1/2" |
| 4 | 7953 | Flat Washer, 3/8" |

| PARTS LIST | | |
|------------|--------|------------------------|
| Item | Part # | Description |
| 5 | 7952 | Lock Nut, 3/8" |
| 6 | 7865 | Lower Vertical Channel |
| 7 | 7951 | Hex Bolt, 12mm x 90mm |
| 8 | 7669 | Lock Nut, 12mm |

| | | | |
|--------------|---|---------------------|------------|
| Title | Airguard Blockage Prevention System Upgrade Instructions | RELEASE DATE | 2024-04-11 |
| STEP | 29. Attach 8” flex hose (Item 1) to snorkel housing (Item 2) using bridge clamp (Item 3). Zip tie 8” flex hoses to reduce wear and ensure tidy installation. Trim 8” hose length to suit. | REV # | 2.0 |
| | | PART KIT # | Varies |

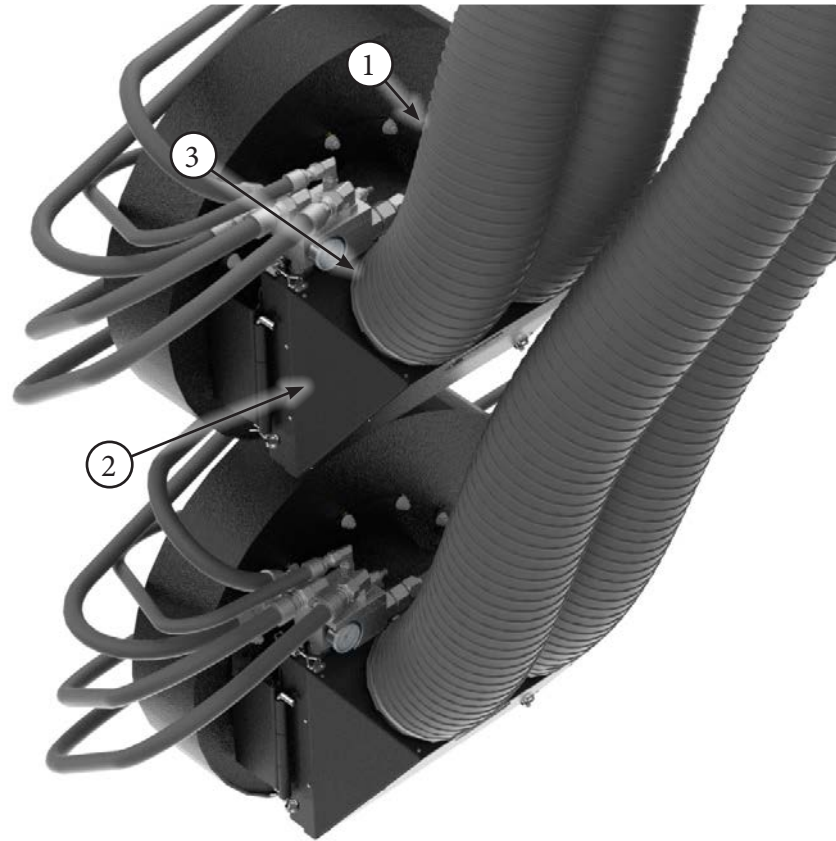

| PARTS LIST | | |
|------------|--------|------------------|
| Item | Part # | Description |
| 1 | 7977 | Snorkel Housing |
| 2 | 7578 | Bridge Clamp, 8” |

| PARTS LIST | | |
|------------|--------|----------------------------|
| Item | Part # | Description |
| 3 | 7572 | Flexible Snorkel Hose - 8” |

| | | | |
|--------------|--|---------------------|------------|
| Title | Airguard Blockage Prevention System Upgrade Instructions | RELEASE DATE | 2024-04-11 |
| STEP | Installation is Completed. Ensure all hydraulic connections and bolts are tightened. | REV # | 2.0 |
| | | PART KIT # | Varies |

COMPLETED INSTALLATION WITH NO SNORKEL

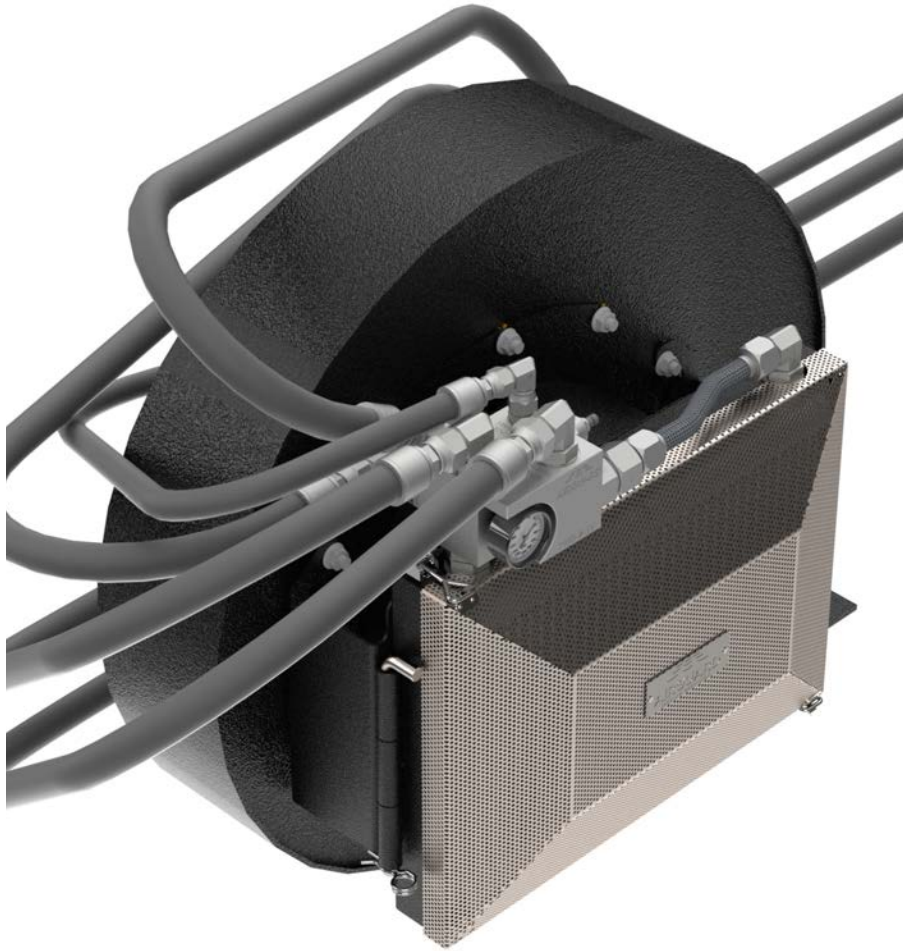

COMPLETED INSTALLATION WITH SNORKELS



| | | | |
|--------------|--|---------------------|------------|
| Title | Airguard Blockage Prevention System Upgrade Instructions | RELEASE DATE | 2024-04-11 |
| STEP | Troubleshooting and preventative maintenance. | REV # | 2.0 |
| | | PART KIT # | Varies |

PREVENTATIVE MAINTENANCE

1. Ensure that the startup procedure on page 16 is performed every morning before seeding begins.
2. Take extra precautions when seeding in cold weather.
3. It is recommended that a bypass valve is purchased to allow for quicker startup.

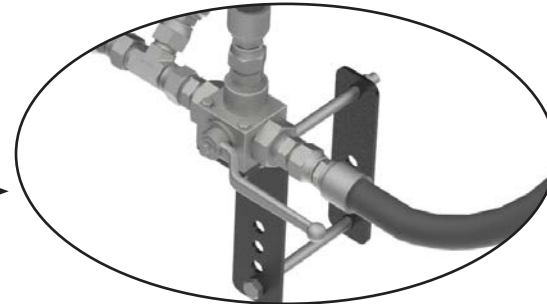

TROUBLESHOOTING

| Trouble | Probable Cause | Remedy |
|--|---|---|
| Fluctuating pressures on pressure gauges and strange noises coming from fan motor. | High return line pressure | The logic cartridge on the BP System is set to 750psi. Any value close to or above that will cause fluctuations and issues with fan speed, this is acting as it is designed. Reduce return line pressure to fix this problem. |
| | Faulty quick disconnect couplers | Replace quick disconnect couplers, inspect ball valve to ensure proper working order |
| | Restriction in return line due to small fitting | Replace fitting with a larger one |
| | Logic cartridge is contaminated | Clean or replace the logic cartridge as needed |
| Fan won't run | High return line pressure | The logic cartridge on the BP System is set to 750psi. Any value close to or above that will cause fluctuations and issues with fan speed. Reduce return line pressure to fix this problem. |
| | Quick couplers are disconnected | Ensure that quick couplers are connected properly |
| | Logic cartridge is contaminated | Clean or replace the logic cartridge as needed |
| | Logic cartridge is faulty | Replace the logic cartridge |
| | Hoses are hooked up incorrectly | Consult owner's manual to see proper installation of hoses |

| | | | |
|--------------|--|---------------------|------------|
| Title | Airguard Blockage Prevention System Upgrade Instructions | RELEASE DATE | 2024-04-11 |
| STEP | Frequently asked questions. | REV # | 2.0 |
| | | PART KIT # | Varies |

FREQUENTLY ASKED QUESTIONS

Q: Why can't I operate my Blockage Prevention System without warming up my tractor first?

A: Tractor motors and seeding equipment are built to withstand fast startups; an aluminum radiator is not. On a cold day at 10% oil flow, your return pressure could be at 500psi on our Blockage Prevention System. If you were to do a fast startup in cold conditions, you could have a radiator fail. Pressures could dramatically spike beyond the capacity of our 2400psi rated aluminum core.

Q: Will the Blockage Prevention System cause dramatic pressure drops in my oil flow?

A: While the BPS will cause a slight pressure drop (approximately 400 RPM or less), the drop in oil flow is negated because of the warm air being transferred from the oil into the airstream. This allows the internal product to flow more efficiently. The reason for the slight pressure drop is that the oil has to pass through the orifices of the radiator, which are smaller than the hoses used prior to the installation of the Blockage Prevention System.

Q: Does the Blockage Prevention System actually work?

A: We can honestly say that it does. The hotter the oil is in the hydraulic lines, the more heat the Blockage Prevention System can extract out of that oil. Since the mechanism is mounted on the face of the fan housing, the fan is pulling air through the fins of the radiator while the air cart is pressurizing up to operate. The hot oil, running through the radiator, acts like a furnace and changes the air temperature on the inside face of the radiator. That air is then pulled into the air cart stream and is pushed out towards the openers, where the seed is placed into the furrow. Warmer air holds more moisture. Humidity will stay in a vapor state when it is drawn in and will be less likely to turn into a liquid while the air and all the hoses and internal components are physically warmer. This allows the product to flow through with less resistance and minimizes buildup of dusty fertilizer internally. Seed and fertilizer will be delivered to the discharge outlets without problems.

Q: What is the purpose of the new bypass valve?

A: The new bypass valve upgrade kit allows you to heat up your oil before engaging your Blockage Prevention System. You can also choose whether or not to use your BPS in the heat of the day.

Q: What pressure should the pressure gauge read on the Blockage Prevention System?

A: 300-600psi is an acceptable pressure range when operating. The gauge reads the pressure of the oil going through the radiator, on the return side of the fan motor.

Q: Do I need to reset the relief valves on the V2 Blockage Prevention System?

A: No you do not. The valves are preset to 750psi and 850psi. If they do get changed or altered, please contact Airguard in order to have them reset.